

Price List 2022 - rev.00



..2.0 Two Ducts Zero Outdoor Units

CODE	MODEL	DESCRIPTION	PRICE
CZMO09IC3II	..2.0 MINI 9 HP DC Inverter	Monobloc aircon without outdoor condensing unit - DC INVERTER DUAL POWER with APP, R290 (PROPANE) gas	€ 2 260,00
CBMO10IC3II	..2.0 10 HP DC Inverter	Monobloc aircon without outdoor condensing unit - DC INVERTER DUAL POWER with APP, R32 gas	€ 2 260,00 NEW
CBMO12IC3II	..2.0 12 HP DC Inverter	Monobloc aircon without outdoor condensing unit - DC INVERTER DUAL POWER with APP, R32 gas	€ 2 430,00 NEW
CZMO15IC3II	..2.0 15 MAXI HP DC Inverter	Monobloc aircon without outdoor condensing unit, 200 mm holes - DC INVERTER DUAL POWER with APP, R32 gas	€ 2 650,00
CBMR12IC3II	..2.0 12 HP DC Inverter Elec	Monobloc aircon without outdoor condensing unit with electrical heater - DC INVERTER DUAL POWER with APP, R32 gas	€ 2 650,00 NEW

..2.0 Accessories

CODE	DESCRIPTION	PRICE
ECA031II	Wall mounting SMART TOUCH remote control with WIFI, black colour	€ 175,00
ECB031II	Wall mounting SMART TOUCH remote control with WIFI, white colour	€ 175,00
ECA032II	SMART TOUCH electronic wall control panel with thermostat and room probe with integrated Mpd bus port (supplied with 8m connection cable), black colour	€ 175,00 NEW
ECB032II	SMART TOUCH electronic wall control panel with thermostat and room probe with integrated Mpd bus port (supplied with 8m connection cable), white colour	€ 175,00 NEW
GB0738II	Kit n. 2 aluminium grills with fixed fins 160 mm for outdoor use	€ 75,00
GB1091II	Kit n. 2 aluminium grills with fixed fins 200 mm for outdoor use, ..2.0 15 HP MAXI	€ 100,00
GB0739II	Kit n. 2 rain protections for 160 mm (to be fixed above fixed outdoor grills)	€ 125,00
GB0737II	Cover for lower side of ..2.0 (in case of high wall installation) - standard versions, 12HP - 12 HP Elec - 10 HP e 15 H MAXI	€ 65,00
GB1105II	Cover for lower side of ..2.0 (in case of high wall installation) -only for ..2.0 MINI model	€ 65,00
GB0671II	Pre-installation kit ..2.0 holes 160 mm with: external flaps, flanges, template, support bracket, wall crossing pipes, 12HP - 12 HP Elec - 10 HP	€ 80,00
GB1092II	Pre-installation kit ..2.0 holes 200 mm with: external flaps, flanges, template, support bracket, wall crossing pipes, 15 HP MAXI	€ 80,00
GB1109II	Pre-installation kit ..2.0 MINI mm with: external flaps, flanges, template, support bracket, wall crossing tubes	€ 80,00 NEW
GB0755II	Auxiliary kit for protection against insects, for 160 mm aluminum fixed grill -only for air intake hole	€ 65,00
GB0740II	Special kit for installation on glass walls, 10 HP - 12 HP - 12 HP elec	€ 230,00
GR0765II	Fresh air kit to renew indoor air on living rooms	€ 740,00
L00771II	Special "wall concealed" casing for angular external air outlet on RIGHT side (including additional fan), 10 HP - 12 HP - 12 HP elec- 15 HP MAXI	€ 890,00
L00772II	Special "wall concealed" casing for angular external air outlet on LEFT side (including additional fan), 10 HP - 12 HP - 12 HP elec- 15 HP MAXI	€ 890,00
GB1104II	UV-C lamp only for ..2.0 12 HP (factory fitted)	€ 470,00 NEW
GR1232II	Replacement UCV lamp kit, 12 HP	€ 250,00 NEW



..2.0 Vertical, two Ducts Zero Outdoor Units

CODE	MODEL	DESCRIPTION	PRICE
COMV10IC3II	..2.0 Vert 10 HP DC Inverter	Monobloc vertical aircon without outdoor condensing unit - DC INVERTER DUAL POWER with APP	€ 2 760,00
COMV12IC3II	..2.0 Vert 12 HP DC Inverter	Monobloc vertical aircon without outdoor condensing unit - DC INVERTER DUAL POWER with APP	€ 2 980,00

..2.0 Vertical accessories

CODE	DESCRIPTION	PRICE
ECA031II	SMART TOUCH electronic wall control panel with thermostat and room probe and WIFI, black colour	€ 160,00
ECB031II	SMART TOUCH electronic wall control panel with thermostat and room probe and WIFI, white colour	€ 160,00
ECA032II	SMART TOUCH electronic wall control panel with thermostat and room probe with integrated Mpdbus port (supplied with 8m connection cable), black colour	€ 175,00 NEW
ECB032II	SMART TOUCH electronic wall control panel with thermostat and room probe with integrated Mpdbus port (supplied with 8m connection cable), white colour	€ 175,00 NEW
GB0738II	Kit n. 2 aluminium grills with fixed fins 160 mm for outdoor use	€ 75,00
GB0739II	Kit n. 2 rain protections for 160 mm (to be fixed above fixed outdoor grills)	€ 125,00
GB0755II	Auxiliary kit for protection against insects, for 160 mm aluminum fixed grill -only for air intake hole	€ 65,00

..2.0 FCU without outdoor condensing unit, with integrated fancoil

CODE	MODEL	DESCRIPTION	PRICE
CBFB10IC3II	..2.0 10 HP DC Inverter	Monobloc aircon without outdoor condensing unit to be coupled with FCU with APP	€ 2 260,00 NEW
CBFB12IC3II	..2.0 12 HP DC Inverter	Monobloc aircon without outdoor condensing unit to be coupled with FCU with APP	€ 2 430,00 NEW
CZFC04IC2II	FCU	Convector to be integrated to any of ..2.0 shown above	€ 1 140,00

..2.0 FCU Accessories

CODE	DESCRIPTION	PRICE
ECA031II	SMART TOUCH electronic wall control panel with thermostat and room probe and WIFI, black colour	€ 175,00
ECB031II	SMART TOUCH electronic wall control panel with thermostat and room probe and WIFI, white colour	€ 175,00
ECA032II	SMART TOUCH electronic wall control panel with thermostat and room probe with integrated Mpdbus port (supplied with 8m connection cable), black colour	€ 175,00 NEW
ECB032II	SMART TOUCH electronic wall control panel with thermostat and room probe with integrated Mpdbus port (supplied with 8m connection cable), white colour	€ 175,00 NEW
GB0738II	Kit n. 2 aluminium grills with fixed fins 160 mm for outdoor use	€ 75,00
GB0739II	Kit n. 2 rain protections for 160 mm (to be fixed above fixed outdoor grills)	€ 125,00
GB0755II	Auxiliary kit for protection against insects, for 160 mm aluminum fixed grill -only for air intake hole	€ 65,00

*Niniejsza oferta handlowa nie stanowi oferty w rozumieniu przepisów Kodeksu Cywilnego oraz innych właściwych przepisów.

Price List 2022 - rev.00



Airleaf DC Inverter fancoils: SLI built in 2 pipes

CODE	MODEL	DESCRIPTION	PRICE
FASI02001II	SLI 200	Built in DC Inverter fancoil for horizontal and vertical installation	€ 350,00
FASI04001II	SLI 400	Built in DC Inverter fancoil for horizontal and vertical installation	€ 400,00
FASI06001II	SLI 600	Built in DC Inverter fancoil for horizontal and vertical installation	€ 465,00
FASI08001II	SLI 800	Built in DC Inverter fancoil for horizontal and vertical installation	€ 545,00
FASI10001II	SLI 1000	Built in DC Inverter fancoil for horizontal and vertical installation	€ 600,00

- Prices are for products without accessories (control panel, valves, etc.).
- On demand, some accessories (see following paragraphs) can be factory mounted without any extra cost.
- For connections on the RIGHT (available on all models), extra cost for code BB0646II (see below description) will be added.

Airleaf DC Inverter fancoils: SLI built in 4 pipes

CODE	MODEL	DESCRIPTION	PRICE
FA4I02001II	SLI 200 C 4 pipes	Built in DC Inverter fan coil for 4 pipes application with double coil	€ 495,00
FA4I04001II	SLI 400 C 4 pipes	Built in DC Inverter fan coil for 4 pipes application with double coil	€ 550,00
FA4I06001II	SLI 600 C 4 pipes	Built in DC Inverter fan coil for 4 pipes application with double coil	€ 620,00
FA4I08001II	SLI 800 C 4 pipes	Built in DC Inverter fan coil for 4 pipes application with double coil	€ 745,00
FA4I10001II	SLI 1000 C 4 pipes	Built in DC Inverter fan coil for 4 pipes application with double coil	€ 805,00

- Prices are for products without accessories (control panel, valves, etc.).
- On demand, some accessories (see following paragraphs) can be factory mounted without any extra cost.
- For connections on the RIGHT (available on all models), extra cost for code BB0646II (see below description) will be added.

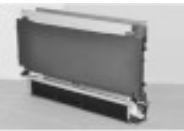

Airleaf DC Inverter fancoils: RSI built in 2 pipes with FRONT RADIATING EFFECT

CODE	MODEL	DESCRIPTION	PRICE
FASS02S01II	RSI 200	Built in DC Inverter fancoil for vertical installation WITH FRONT RADIATING EFFECT	€ 505,00
FASS04S01II	RSI 400	Built in DC Inverter fancoil for vertical installation WITH FRONT RADIATING EFFECT	€ 595,00
FASS06S01II	RSI 600	Built in DC Inverter fancoil for vertical installation WITH FRONT RADIATING EFFECT	€ 685,00
FASS08S01II	RSI 800	Built in DC Inverter fancoil for vertical installation WITH FRONT RADIATING EFFECT	€ 800,00
FASS10S01II	RSI 1000	Built in DC Inverter fancoil for vertical installation WITH FRONT RADIATING EFFECT	€ 900,00

- Prices are for products without accessories (control panel, valves, etc.).
- On demand, some accessories (see following paragraphs) can be factory mounted without any extra cost.
- For connections on the RIGHT (available on all models) extra cost for code BB0646II (see below description) will be added.



Airleaf DC Inverter fancoils: SLSI (SHORT HEIGHT) built in 2 pipes

CODE	MODEL	DESCRIPTION	PRICE
FALI02S01II	SLSI 200	Built in DC Inverter, short height fancoil for vertical installation only	€ 495,00
FALI04S01II	SLSI 400	Built in DC Inverter, short height fancoil for vertical installation only	€ 540,00
FALI06S01II	SLSI 600	Built in DC Inverter, short height fancoil for vertical installation only	€ 630,00
FALI08S01II	SLSI 800	Built in DC Inverter, short height fancoil for vertical installation only	€ 720,00
FALI10S01II	SLSI 1000	Built in DC Inverter, short height fancoil for vertical installation only	€ 805,00

- Prices are for products without accessories (control panel, valves, etc.).
- On demand, some accessories (see following paragraphs) can be factory mounted without any extra cost.
- For connections on the RIGHT (available on all models) extra cost for code BB0646II (see below description) will be added.



Airleaf DC Inverter fancoils: SL 2 pipes

CODE	MODEL	DESCRIPTION	PRICE
FASL02SC1II	SL200C	DC Inverter fan coil unit with sheet metal cabinet (white colour)	€ 495,00
FASL04SC1II	SL400C	DC Inverter fan coil unit with sheet metal cabinet (white colour)	€ 545,00
FASL06SC1II	SL600C	DC Inverter fan coil unit with sheet metal cabinet (white colour)	€ 635,00
FASL08SC1II	SL800C	DC Inverter fan coil unit with sheet metal cabinet (white colour)	€ 755,00
FASL10SC1II	SL1000C	DC Inverter fan coil unit with sheet metal cabinet (white colour)	€ 850,00

- Prices are for products without accessories (control panel, valves, etc.).
- On demand, some accessories (see following paragraphs) can be factory mounted without any extra cost.
- For "below the ceiling" horizontal installation, do foresee the need (see : Accessories) of the horizontal drain pan
- For special RAL colours: extra € 350 each manufacturing lot (min 5 pcs).



Airleaf DC Inverter fancoils: SL 4 pipes

CODE	MODEL	DESCRIPTION	PRICE
FA4L02SC1II	SL 200 C 4 pipes	DC Inverter fan coil unit with sheet metal cabinet for 4 pipes application with double coil (white colour)	€ 630,00
FA4L04SC1II	SL 400 C 4 pipes	DC Inverter fan coil unit with sheet metal cabinet for 4 pipes application with double coil (white colour)	€ 715,00
FA4L06SC1II	SL 600 C 4 pipes	DC Inverter fan coil unit with sheet metal cabinet for 4 pipes application with double coil (white colour)	€ 830,00
FA4L08SC1II	SL 800 C 4 pipes	DC Inverter fan coil unit with sheet metal cabinet for 4 pipes application with double coil (white colour)	€ 975,00
FA4L10SC1II	SL 1000 C 4 pipes	DC Inverter fan coil unit with sheet metal cabinet for 4 pipes application with double coil (white colour)	€ 1 055,00

- Prices are for products without accessories (control panel, valves, etc.).
- On demand, some accessories (see following paragraphs) can be factory mounted without any extra cost.
- For connections on the RIGHT (available on all models) extra cost for code BB0646II (see below description) will be added.
- For "below the ceiling" horizontal installation, do foresee the need (see : Accessories) of the horizontal drain pan
- For special RAL colours: extra € 350 each manufacturing lot (min 5 pcs).



Airleaf DC Inverter fancoils: SL 2 pipes FULL FLAT

CODE	MODEL	DESCRIPTION	PRICE
FAFL02SC1II	SL 200 C FULL FLAT	DC Inverter fan coil unit with sheet metal cabinet and motorized FULL FLAT front suction panel (white colour)	€ 565,00
FAFL04SC1II	SL 400 C FULL FLAT	DC Inverter fan coil unit with sheet metal cabinet and motorized FULL FLAT front suction panel (white colour)	€ 620,00
FAFL06SC1II	SL 600 C FULL FLAT	DC Inverter fan coil unit with sheet metal cabinet and motorized FULL FLAT front suction panel (white colour)	€ 690,00
FAFL08SC1II	SL 800 C FULL FLAT	DC Inverter fan coil unit with sheet metal cabinet and motorized FULL FLAT front suction panel (white colour)	€ 830,00
FAFL10SC1II	SL 1000 C FULL FLAT	DC Inverter fan coil unit with sheet metal cabinet and motorized FULL FLAT front suction panel (white colour)	€ 910,00

- Prices are for products without accessories (control panel, valves, etc.).
- On demand, some accessories (see following paragraphs) can be factory mounted without any extra cost.
- For connections on the RIGHT (available on all models) extra cost for code BB0646II (see below description) will be added.
- Only VERTICAL (wall) installation is allowed.
- For special RAL colours: extra € 350 each manufacturing lot (min 5 pcs).



Airleaf DC Inverter fancoils: SLS (reduced height) 2 pipes

CODE	MODEL	DESCRIPTION	PRICE
FALS02SC1II	SLS 200C	DC Inverter reduced height fancoil (370 mm) with sheet metal cabinet (white colour) ONLY for vertical installation	€ 500,00
FALS04SC1II	SLS 400C	DC Inverter reduced height fancoil (370 mm) with sheet metal cabinet (white colour) ONLY for vertical installation	€ 545,00
FALS06SC1II	SLS 600C	DC Inverter reduced height fancoil (370 mm) with sheet metal cabinet (white colour) ONLY for vertical installation	€ 635,00
FALS08SC1II	SLS 800C	DC Inverter reduced height fancoil (370 mm) with sheet metal cabinet (white colour) ONLY for vertical installation	€ 725,00
FALS10SC1II	SLS 1000C	DC Inverter reduced height fancoil (370 mm) with sheet metal cabinet (white colour) ONLY for vertical installation	€ 815,00

- Prices are for products without accessories (control panel, valves, etc.).
- On demand, some accessories (see following paragraphs) can be factory mounted without any extra cost.
- For connections on the RIGHT (available on all models) extra cost for code BB0646II (see below description) will be added.
- Only VERTICAL (wall) installation is allowed.
- For special RAL colours: extra € 350 each manufacturing lot (min 5 pcs).



Airleaf DC Inverter fancoils: RS 2 pipes with FRONT RADIATING EFFECT

CODE	MODEL	DESCRIPTION	PRICE
FARS02SC1II	AirLeaf RS 200 C	DC Inverter fan coil unit with sheet metal cabinet and FRONT RADIATING EFFECT (white colour)	€ 665,00
FARS04SC1II	AirLeaf RS 400 C	DC Inverter fan coil unit with sheet metal cabinet and FRONT RADIATING EFFECT (white colour)	€ 765,00
FARS06SC1II	AirLeaf RS 600 C	DC Inverter fan coil unit with sheet metal cabinet and FRONT RADIATING EFFECT (white colour)	€ 860,00
FARS08SC1II	AirLeaf RS 800 C	DC Inverter fan coil unit with sheet metal cabinet and FRONT RADIATING EFFECT (white colour)	€ 1 010,00
FARS10SC1II	AirLeaf RS 1000 C	DC Inverter fan coil unit with sheet metal cabinet and FRONT RADIATING EFFECT (white colour)	€ 1 145,00

- Prices are for products without accessories (control panel, valves, etc.).
- On demand, some accessories (see following paragraphs) can be factory mounted without any extra cost.
- For connections on the RIGHT (available on all models) extra cost for code BB0646II (see below description) will be added.
- Only VERTICAL (wall) installation is allowed.
- For special RAL colours: extra € 350 each manufacturing lot (min 5 pcs).



Airleaf DC Inverter fancoils: RS 2 pipes FULL FLAT with FRONT RADIATING EFFECT

CODE	MODEL	DESCRIPTION	PRICE
FAFS02SC1II	AirLeaf RS 200 B FULL FLAT	DC Inverter fan coil unit with sheet metal cabinet, FRONT RADIATING EFFECT and motorized FULL FLAT front suction panel(white colour)	€ 735,00
FAFS04SC1II	AirLeaf RS 400 B FULL FLAT	DC Inverter fan coil unit with sheet metal cabinet, FRONT RADIATING EFFECT and motorized FULL FLAT front suction panel(white colour)	€ 840,00
FAFS06SC1II	AirLeaf RS 600 B FULL FLAT	DC Inverter fan coil unit with sheet metal cabinet, FRONT RADIATING EFFECT and motorized FULL FLAT front suction panel(white colour)	€ 930,00
FAFS08SC1II	AirLeaf RS 800 B FULL FLAT	DC Inverter fan coil unit with sheet metal cabinet, FRONT RADIATING EFFECT and motorized FULL FLAT front suction panel(white colour)	€ 1 100,00
FAFS10SC1II	AirLeaf RS 1000 B FULL FLAT	DC Inverter fan coil unit with sheet metal cabinet, FRONT RADIATING EFFECT and motorized FULL FLAT front suction panel(white colour)	€ 1 200,00

- Prices are for products without accessories (control panel, valves, etc.).
- On demand, some accessories (see following paragraphs) can be factory mounted without any extra cost.
- For connections on the RIGHT (available on all models) extra cost for code BB0646II (see below description) will be added.
- Only VERTICAL (wall) installation is allowed.
- For special RAL colours: extra € 350 each manufacturing lot (min 5 pcs).

Accessories for Airleaf fancoils

Controls for DC Inverter motors

CODE

On board controls (2 pipes):



ECA644II

EWF644II

E4T643II

E2T543II



On board controls (4 pipes):

ECA647II

EWF647II

B3V137II

E4T643II

Wall remoted controls (2 pipes):

ESE645II

EEA649II

EEB649II

EFA649II

EFB649II

EQA649II

EQB649II

ERA649II

ERB649II

EG1028II

DESCRIPTION

On board electronic control SMART TOUCH with PID full modulating fan and thermostat (*)

On board electronic control SMART TOUCH with PID full modulating fan, thermostat and WiFi module (*)

On board electronic control SMART TOUCH 4 speeds with thermostat(*)

On board electronic control 4 speeds with thermostat(*)

On board electronic control TOUCH LCD with PID full modulating fan and thermostat (*)

On board electronic control SMART TOUCH with PID full modulating fan, thermostat and WiFi module (*)

On board speed selector for connection with standard single contact thermostats (*)

On board electronic control LCD 4 speeds with thermostat(*)

On board electronic control with PID full modulating fan for EDA649II-EDB649II-EWG649II-EWW649II wall mounted panel (*)

SMART TOUCH electronic wall control panel with thermostat and room probe (to be coupled from 1 to max 30 ESE645), black colour

SMART TOUCH electronic wall control panel with thermostat and room probe (to be coupled from 1 to max 30 ESE645), white colour

SMART TOUCH electronic wall control panel with thermostat and room probe (to be coupled from 1 to max 30 ESE645), with WiFi module, black colour

SMART TOUCH electronic wall control panel with thermostat and room probe (to be coupled from 1 to max 30 ESE645), with WiFi module, white colour

Wall-mounted electronic TOUCH LCD control panel with thermostat and temperature, relative humidity and room air quality probe. Black colour

Wall-mounted electronic TOUCH LCD control panel with thermostat and temperature, relative humidity and room air quality probe. White colour

Wall-mounted electronic TOUCH LCD control panel with thermostat and temperature, relative humidity and room air quality probe with integrated WiFi module. Black colour

Wall-mounted electronic TOUCH LCD control panel with thermostat and temperature, relative humidity and room air quality probe with integrated WiFi module. White colour

MZS, single zone module

PRICE

€ 180,00

€ 205,00

€ 140,00

€ 105,00

€ 205,00

€ 235,00

€ 95,00

€ 140,00

€ 140,00

€ 140,00 **NEW**

€ 140,00 **NEW**

€ 175,00 **NEW**

€ 175,00 **NEW**

€ 170,00 **NEW**

€ 170,00 **NEW**

€ 200,00 **NEW**

€ 200,00 **NEW**

€ 85,00

Wall remotated controls (4 pipes):

ESE648II	On board electronic control with PID full modulating fan for EDA649II-EDB649II-EWG649II-EWW649II wall mounted panel (*)	€ 185,00	
EEA649II	SMART TOUCH electronic wall control panel with thermostat and room probe (to be coupled from 1 to max 30 ESE645), black colour	€ 140,00	NEW
EEB649II	SMART TOUCH electronic wall control panel with thermostat and room probe (to be coupled from 1 to max 30 ESE645), white colour	€ 140,00	NEW
EFA649II	SMART TOUCH electronic wall control panel with thermostat and room probe (to be coupled from 1 to max 30 ESE645), with WiFi module, black colour	€ 175,00	NEW
EFB649II	SMART TOUCH electronic wall control panel with thermostat and room probe (to be coupled from 1 to max 30 ESE645), with WiFi module, white colour	€ 175,00	NEW
EQA649II	Wall-mounted electronic TOUCH LCD control panel with thermostat and temperature, relative humidity and room air quality probe. Black colour	€ 170,00	NEW
EQB649II	Wall-mounted electronic TOUCH LCD control panel with thermostat and temperature, relative humidity and room air quality probe. White colour	€ 170,00	NEW
ERA649II	Wall-mounted electronic TOUCH LCD control panel with thermostat and temperature, relative humidity and room air quality probe with integrated WiFi module. Black colour	€ 200,00	NEW
ERB649II	Wall-mounted electronic TOUCH LCD control panel with thermostat and temperature, relative humidity and room air quality probe with integrated WiFi module. White colour	€ 200,00	NEW
B4V642II	Controllo elettronico a bordo per il collegamento con termostati a parete standard a 3 velocità, per 2 e 4 tubi (*)	€ 100,00	
B10642II	Controllo elettronico a bordo con connessioni analogiche 0-10V, per 2 tubi (*)	€ 100,00	



Wall mounted thermostats with 4 speeds switch:

B3V151II	Wall mounted control with thermostat, summer/winter and speed selectors, to be coupled with B4V642II- for 2 pipes	€ 165,00	
B3V152II	Concealed control with thermostat, summer/winter and speed selectors, to be coupled with B4V642II- for 2 pipes	€ 205,00	
BB0646II	BUTLER: codes, accessories and price list described in the appropriate section Motor connection cable to shift water connections from left to right (*)	€ 30,00	NEW



(*) Accessories that can be factory mounted without any extra cost

Hydraulic groups

CODE	DESCRIPTION	PRICE
V20139II	2 way valve group (water inlet valve, shut off valve and electro thermal motor)SL, RS, SLI, RSI (*)	€ 145,00
V20661II	2 way valve group (water inlet valve, shut off valve and electro thermal motor) for SLS, SLSI models (*)	€ 230,00
V30361II	3 way valve group (with inlet 3 way valve, shut off valve, and electro thermal motor SL, RS, SLI, RSI(*)	€ 180,00
V30662II	3 way valve group (water inlet valve, shut off valve and electro thermal motor) for SLS ed SLSI models (*)	€ 250,00
I20205II	2 way valve group with manual closure (*)	€ 65,00
I20705II	2 way valve group with manual closure for SLS models (*)	€ 75,00
V40219II	2 way hydraulic group for 4 pipe system (*)	€ 335,00
V60221II	3 way hydraulic group for 4 pipe system (*)	€ 465,00
Ai0200II	Couple of EUROKONUS adapters for 1\2" female connection (male fittings)	€ 22,00
Ai0201II	Couple of EUROKONUS adapters for 3/4" female connection (male fittings)	€ 22,00
Ai0203II	90° bended EUROKONUS connector	€ 23,00
Ai0501II	Distancer kit (1 piece)	€ 23,00
Ai0612II	Adaptors for flat ring	€ 12,00

(*) Accessories that can be factory mounted without any extra cost

Special accessories for installation



Cover feet

CODE

LC0157II

DESCRIPTION

Sheet metal feet to cover pipes from the floor (white colour)

PRICE

€ 50,00

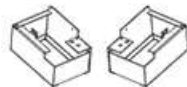

Floor fixing feet

CODE

LC0605II

DESCRIPTION

Sheet metal feet to fix FCU to the floor (white colour)

PRICE

€ 90,00



Condensate collector tray for horizontal installation, SL models

CODE

GB0520II

DESCRIPTION

Condensate collector tray for SL 200 (2 and 4 pipe version) for ceiling installation (*)

PRICE

€ 55,00

GB0521II

Condensate collector tray for SL 400 (2 and 4 pipe version) for ceiling installation (*)

€ 65,00

GB0522II

Condensate collector tray for SL 600 (2 and 4 pipe version) for ceiling installation (*)

€ 70,00

GB0523II

Condensate collector tray for SL 800 (2 and 4 pipe version) for ceiling installation (*)

€ 90,00

GB0524II

Condensate collector tray for SL 1000 (2 and 4 pipe version) for ceiling installation (*)

€ 95,00

(*) Accessories that can be factory mounted without any extra cost

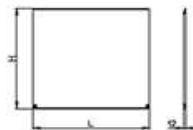

Rear metal cover panel

CODE

LC0171II

DESCRIPTION

Sheet metal white colour back panel for SL 200 (2 pipe unit)

€ 125,00

LC0173II

Sheet metal white colour back panel for SL 400 (2 pipe unit)

€ 135,00

LC0175II

Sheet metal white colour back panel for SL 600 (2 pipe unit)

€ 150,00

LC0177II

Sheet metal white colour back panel for SL 800 (2 pipe unit)

€ 165,00

LC0179II

Sheet metal white colour back panel for SL 1000 (2 pipe unit)

€ 175,00



Air intake suction duct

CODE

DB0194II
DB0195II
DB0196II
DB0197II
DB0198II

DESCRIPTION

Air intake suction duct for SLI 200 units
Air intake suction duct for SLI 400 units
Air intake suction duct for SLI 600 units
Air intake suction duct for SLI 800 units
Air intake suction duct for SLI 1000 units

PRICE

€ 55,00
€ 65,00
€ 70,00
€ 85,00
€ 90,00

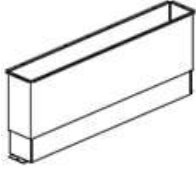

Telescopic Air Flow duct

CODE

DB0160II
DB0161II
DB0162II
DB0163II
DB0164II

DESCRIPTION

variable lenght air flow duct for SLI 200 false ceiling built in installation
variable lenght air flow duct for SLI 400 false ceiling built in installation
variable lenght air flow duct for SLI 600 false ceiling built in installation
variable lenght air flow duct for SLI 800 false ceiling built in installation
variable lenght air flow duct for SLI 1000 false ceiling built in installation

PRICE

€ 120,00
€ 135,00
€ 160,00
€ 175,00
€ 195,00

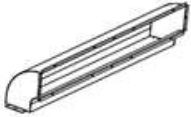

90° Bended Duct

CODE

DB0165II
DB0166II
DB0167II
DB0168II
DB0169II

DESCRIPTION

90° bended duct for SLI 200 false ceiling built in installation
90° bended duct for SLI 400 false ceiling built in installation
90° bended duct for SLI 600 false ceiling built in installation
90° bended duct for SLI 800 false ceiling built in installation
90° bended duct for SLI 1000 false ceiling built in installation

PRICE

€ 55,00
€ 65,00
€ 75,00
€ 85,00
€ 90,00

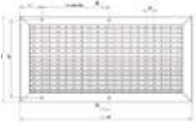

Air flow vent grills

CODE

DR0321II
DR0322II
DR0323II
DR0324II
DR0325II

DESCRIPTION

Air flow vent aluminum grill wall mounted version for SLI 200 units
Air flow vent aluminum grill wall mounted version for SLI 400 units
Air flow vent aluminum grill wall mounted version for SLI 600 units
Air flow vent aluminum grill wall mounted version for SLI 800 units
Air flow vent aluminum grill wall mounted version for SLI 1000 units

PRICE

€ 145,00
€ 175,00
€ 215,00
€ 255,00
€ 270,00

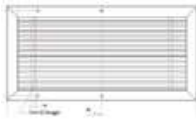

Air intake grills

CODE

DR0326II
DR0327II
DR0328II
DR0329II
DR0330II

DESCRIPTION

Air intake aluminum grill with straight profile for SLI 200 units
Air intake aluminum grill with straight profile for SLI 400 units
Air intake aluminum grill with straight profile for SLI 600 units
Air intake aluminum grill with straight profile for SLI 800 units
Air intake aluminum grill with straight profile for SLI 1000 units

PRICE

€ 120,00
€ 150,00
€ 175,00
€ 210,00
€ 240,00



UV-C lamp for sterilisation

CODE

GB0545II
 GB0546II
 GB0547II
 GB0548II
 GB0549II

DESCRIPTION

UV-C air sterilization device for 200 series fancoil units (*)
 UV-C air sterilization device for 400 series fancoil units (*)
 UV-C air sterilization device for 600 series fancoil units (*)
 UV-C air sterilization device for 800 series fancoil units (*)
 UV-C air sterilization device for 1000 series fancoil units (*)

PRICE

€ 400,00
 € 420,00
 € 450,00
 € 710,00
 € 730,00

(*) Accessories that can be factory mounted without any extra cost



Lampada UV per sterilizzazione

CODICE

GB1107II
 GR1231II

DESCRIZIONE

Air sterilisation device with UVC lamp for SLI 200, 400, 600, 800, 1000
 Replacement UVC lamp kit

PREZZO

€ 470,00
 € 250,00

NEW
NEW

(*) Accessories that can be changed at the factory at no extra cost



Curved air flow vent

CODE

DR0550II
 DR0551II
 DR0552II
 DR0553II
 DR0554II

DESCRIPTION

Air flow vent with aluminum curved profile for SLI 200 units
 Air flow vent with aluminum curved profile for SLI 400 units
 Air flow vent with aluminum curved profile for SLI 600 units
 Air flow vent with aluminum curved profile for SLI 800 units
 Air flow vent with aluminum curved profile for SLI 1000 units

PRICE

€ 95,00
 € 110,00
 € 115,00
 € 125,00
 € 140,00

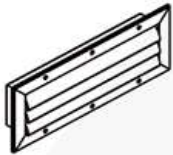

Curved air intake grill

CODE

DR0559II
 DR0560II
 DR0561II
 DR0562II
 DR0563II

DESCRIPTION

Air intake aluminum grill with curved profile for SLI 200 units
 Air intake aluminum grill with curved profile for SLI 400 units
 Air intake aluminum grill with curved profile for SLI 600 units
 Air intake aluminum grill with curved profile for SLI 800 units
 Air intake aluminum grill with curved profile for SLI 1000 units

PRICE

€ 120,00
 € 130,00
 € 140,00
 € 150,00
 € 160,00

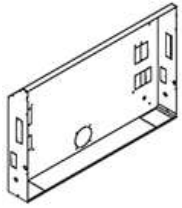

Metal casing

CODE	DESCRIPTION	PRICE
L00568II	Sheet metal casing for SLI 200 units	€ 120,00
L00569II	Sheet metal casing for SLI 400 units	€ 130,00
L00570II	Sheet metal casing for SLI 600 units	€ 145,00
L00571II	Sheet metal casing for SLI 800 units	€ 160,00
L00572II	Sheet metal casing for SLI 1000 units	€ 170,00
L00700II	Sheet metal casing for SLSI 200 units	€ 120,00
L00701II	Sheet metal casing for SLSI 400 units	€ 140,00
L00702II	Sheet metal casing for SLSI 600 units	€ 150,00
L00703II	Sheet metal casing for SLSI 800 units	€ 165,00
L00704II	Sheet metal casing for SLSI 1000 units	€ 175,00
L01040II	Framework for fully aligned with the wall installation, SLI 200	€ 225,00 NEW
L01041II	Framework for fully aligned with the wall installation, SLI 400	€ 250,00 NEW
L01042II	Framework for fully aligned with the wall installation, SLI 600	€ 280,00 NEW
L01043II	Framework for fully aligned with the wall installation, SLI 800	€ 305,00 NEW
L01044II	Framework for fully aligned with the wall installation, SLI 1000	€ 330,00 NEW
L01049II	Framework for fully aligned with the wall installation, SLSI 200	€ 125,00 NEW
L01050II	Framework for fully aligned with the wall installation, SLSI 400	€ 147,00 NEW
L01051II	Framework for fully aligned with the wall installation, SLSI 600	€ 157,00 NEW
L01052II	Framework for fully aligned with the wall installation, SLSI 800	€ 174,00 NEW
L01053II	Framework for fully aligned with the wall installation, SLSI 1000	€ 184,00 NEW
L01064II	Framework sheet metal formwork for built-in installation of fan coil unit SLI 4 pipes 200	€ 135,00 NEW
L01065II	Framework sheet metal formwork for flush-mounted installation of fan coil unit SLI 4 pipes 400	€ 145,00 NEW
L01066II	Framework sheet metal formwork for recessed installation of fan coil unit SLI 4 pipes 600	€ 160,00 NEW
L01067II	Framework sheet metal formwork for built-in installation of SLI 4-pipe fan coil units 800	€ 175,00 NEW
L01068II	Framework sheet metal formwork for built-in installation of fan coil unit SLI 4 pipes 1000	€ 190,00 NEW



Vertical casing cover

CODE	DESCRIPTION	PRICE
LC0578II	Casing cover panel with intake air grill for SLI 200 units (white colour)	€ 250,00
LC0579II	Casing cover panel with intake air grill for SLI 400 units (white colour)	€ 285,00
LC0580II	Casing cover panel with intake air grill for SLI 600 units (white colour)	€ 315,00
LC0581II	Casing cover panel with intake air grill for SLI 800 units (white colour)	€ 355,00
LC0582II	Casing cover panel with intake air grill for SLI 1000 units (white colour)	€ 390,00
LC0692II	Casing cover panel with intake air grill for SLSI 200 units (white colour)	€ 290,00
LC0693II	Casing cover panel with intake air grill for SLSI 400 units (white colour)	€ 320,00
LC0694II	Casing cover panel with intake air grill for SLSI 600 units (white colour)	€ 355,00
LC0695II	Casing cover panel with intake air grill for SLSI 800 units (white colour)	€ 390,00
LC0696II	Casing cover panel with intake air grill for SLSI 1000 units (white colour)	€ 440,00
LC1081II	Cover panel for vertical installation fully aligned with the wall, , SLI/RSI 200	€ 175,00 NEW
LC1082II	Cover panel for vertical installation fully aligned with the wall, SLI/RSI 400	€ 200,00 NEW
LC1083II	Cover panel for vertical installation fully aligned with the wall, SLI/RSI 600	€ 225,00 NEW
LC1084II	Cover panel for vertical installation fully aligned with the wall, SLI/RSI 800	€ 250,00 NEW
LC1085II	Cover panel for vertical installation fully aligned with the wall, SLI/RSI 1000	€ 275,00 NEW
LC1095II	Cover panel for vertical installation fully aligned with the wall, SLSI 200	€ 290,00
LC1096II	Cover panel for vertical installation fully aligned with the wall, SLSI 400	€ 320,00
LC1097II	Cover panel for vertical installation fully aligned with the wall, SLSI 600	€ 355,00
LC1098II	Cover panel for vertical installation fully aligned with the wall, SLSI 800	€ 390,00
LC1099II	Cover panel for vertical installation fully aligned with the wall, SLSI 1000	€ 440,00
LC0759II	Pannello di copertura con cornice, griglia di aspirazione e aletta di mandata regolabile per installazione ad incasso per unità SLI 4 tubi 200	€ 275,00 NEW
LC0760II	Pannello di copertura con cornice, griglia di aspirazione e aletta di mandata regolabile per installazione ad incasso per unità SLI 4 tubi 400	€ 315,00 NEW
LC0761II	Pannello di copertura con cornice, griglia di aspirazione e aletta di mandata regolabile per installazione ad incasso per unità, SLI 4 tubi 600	€ 345,00 NEW
LC0762II	Pannello di copertura con cornice, griglia di aspirazione e aletta di mandata regolabile per installazione ad incasso per unità SLI 4 tubi 800	€ 390,00 NEW
LC0763II	Pannello di copertura con cornice, griglia di aspirazione e aletta di mandata regolabile per installazione ad incasso per unitàSLI 4 tubi 1000	€ 430,00 NEW

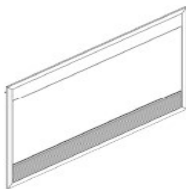

Ceiling casing cover

CODE

LC0618II
LC0619II
LC0620II
LC0621II
LC0622II

DESCRIPTION

Ceiling casing cover panel with accessible air grill for SLI 200 units, horizontal installation (white colour) (*)
Ceiling casing cover panel with accessible air grill for SLI 400 units, horizontal installation (white colour) (*)
Ceiling casing cover panel with accessible air grill for SLI 600 units, horizontal installation (white colour) (*)
Ceiling casing cover panel with accessible air grill for SLI 800 units, horizontal installation (white colour) (*)
Ceiling casing cover panel with accessible air grill for SLI 1000 units, horizontal installation (white colour) (*)

PRICE

€ 250,00
€ 285,00
€ 315,00
€ 355,00
€ 390,00

(*) To be foreseen, for installation, the use of a telescopic air flow duct and an air flow grill.

LC1086II

Cover panel for horizontal installation fully aligned with the wall , SLI 200

€ 175,00

LC1087II

Cover panel for horizontal installation fully aligned with the wall, SLI 400

€ 200,00

LC1088II

Cover panel for horizontal installation fully aligned with the wall, SLI 600

€ 225,00

LC1089II

Cover panel for horizontal installation fully aligned with the wall, SLI 800

€ 250,00

LC1090II

Cover panel for horizontal installation fully aligned with the wall, SLI 1000

€ 275,00

LC0764II

Pannello di copertura a soffitto con cornice e griglia di aspirazione per installazione ad incasso per SLI 4 tubi 200

€ 275,00 **NEW**

LC0765II

Pannello di copertura a soffitto con cornice e griglia di aspirazione per installazione ad incasso per SLI 4 tubi 400

€ 315,00 **NEW**

LC0766II

Pannello di copertura a soffitto con cornice e griglia di aspirazione per installazione ad incasso per SLI 4 tubi 600

€ 345,00 **NEW**

LC0767II

Pannello di copertura a soffitto con cornice e griglia di aspirazione per installazione ad incasso per SLI 4 tubi 800

€ 390,00 **NEW**

LC0768II

Pannello di copertura a soffitto con cornice e griglia di aspirazione per installazione ad incasso per SLI 4 tubi 1000

€ 430,00 **NEW**

*Niniejsza oferta handlowa nie stanowi oferty w rozumieniu przepisów Kodeksu Cywilnego oraz innych właściwych przepisów.

Price List 2022 - rev.00



Filomuro DC Inverter, the high wall fancoil

CODE	MODEL	DESCRIPTION	PRICE
FAWS04DC1II-0Q00	SW 400	High Wall fancoil with electronic onboard touchpad and remote control	725,00 €
FAWS04DC1II-0P00	SW 400	High Wall fancoil with electronic modulating control onboard to be connected to remote wall control	725,00 €
FAWS04DC1II-0T00	SW 400	High Wall fancoil with electronic control onboard to be connected to standard 4 speed wall thermostats	725,00 €
FAWS04DC1II-0V00	SW 400	High Wall fancoil with electronic control onboard for 0-10 V connection	725,00 €
FAWS06DC1II-0Q00	SW 600	High Wall fancoil with electronic onboard touchpad and remote control	800,00 €
FAWS06DC1II-0P00	SW 600	High Wall fancoil with electronic modulating control onboard to be connected to remote wall control	800,00 €
FAWS06DC1II-0T00	SW 600	High Wall fancoil with electronic control onboard to be connected to standard 4 speed wall thermostats	800,00 €
FAWS06DC1II-0V00	SW 600	High Wall fancoil with electronic control onboard for 0-10 V connection	800,00 €
FAWS08DC1II-0Q00	SW 800	High Wall fancoil with electronic onboard touchpad and remote control	880,00 €
FAWS08DC1II-0P00	SW 800	High Wall fancoil with electronic modulating control onboard to be connected to remote wall control	880,00 €
FAWS08DC1II-0T00	SW 800	High Wall fancoil with electronic control onboard to be connected to standard 4 speed wall thermostats	880,00 €
FAWS08DC1II-0V00	SW 800	High Wall fancoil with electronic control onboard for 0-10 V connection	880,00 €
Filomuro XL			
FAWL08DC1II-0Q00	SW XL 800	DC Inverter fan coil unit for wall installation with autonomous electronic control on board and remote control	1 020,00 €
FAWL08DC1II-0P00	SW XL 800	DC Inverter fan coil unit for wall installation with electronic board with continuous modulation for wall control connection	1 020,00 €
FAWL08DC1II-0T00	SW XL 800	DC Inverter fan coil unit for wall installation with electronic board for connection to standard 4-speed thermostats.	1 020,00 €
FAWL08DC1II-0V00	SW XL 800	DC Inverter fan coil unit for wall installation with electronic board for 0-10 V interface	1 020,00 €

- Prices excluding accessories (control panels, valve kits, etc.).
- On request, some accessories can be factory fitted at no extra cost (see notes under Accessories).
- Standard RIGHT hydraulic connections. For left-handed connections, the seventh letter of the code will be "S" (specify when ordering). Item BB0646II must be added to the total price.
- SW XL models are produced with hydraulic connections on the RIGHT-hand side only.



Accessory Filomuro/Filomuro XL

CODICE	DESCRIZIONE	PREZZO
EEA649II	SMART TOUCH wall control panel with thermostat and room probe. Black colour	€ 140,00
EEB649II	SMART TOUCH wall control panel with thermostat and room probe. White colour	€ 140,00
EFA649II	SMART TOUCH electronic wall control panel with thermostat and room probe with integrated WiFi module, InnovAPP. Black colour	€ 175,00
EFB649II	SMART TOUCH electronic wall control panel with thermostat and room probe with integrated WiFi module, InnovAPP. White colour	€ 175,00
B3V151II	Wall mounted control with thermostat, summer/winter selector and speed selector. For 4 speed units	€ 165,00
B3V152II	Wall mounted control with thermostat, summer/winter selector and speed selector. For 4 speed units	€ 205,00
	BUTLER: codes, accessories and price list described in the appropriate section	NEW
BB0646II	only for Filomuro Hydraulic connection configuration on the left (motor connection cable for moving hydraulic connections)	€ 30,00

Hydraulic groups

CODE	DESCRIPTION	PRICE
V20687II	2 way valve group (water inlet valve, shut off valve and electro thermal motor) for SLW models (*)	€ 155,00
V20139II	2-way valve unit (inlet valve and lockshield) with thermoelectric motor for SW XL models (*)	€ 145,00 NEW
V30718II	3-way diverter valve unit with thermoelectric motor (complete with lockshield) for SW XL models (*)	€ 165,00 NEW
V30688II	3 way valve group (with inlet 3 way valve, shut off valve, and electro thermal motor) for SW models (*)	€ 190,00
I20205II	Gruppo valvola 2 vie manuale per modelli SW XL (*)	€ 65,00 NEW
I20686II	2 way valve group with manual closure for SW models (*)	€ 95,00
AI0200II	Couple of EUROKONUS adapters for 1\2" female connection (male fittings)	€ 22,00
AI0201II	Couple of EUROKONUS adapters for 3/4" female connection (male fittings)	€ 22,00
AI0203II	90° bended EUROKONUS connector	€ 23,00
AI0501II	Distancer kit (1 piece)	€ 23,00
AI0612II	Adaptors for flat ring	€ 12,00

(*) Accessories that can be factory mounted without any extra cost, it is mandatory to install 2way or 3way valve



Filomuro Built in

CODE	MODEL	DESCRIPTION	PRICE
For connection with remote keyboard			
FAWI04D01II-0P00	SWI 400	Modulation fan speed. DC Inverter. On board electronic control with PID full modulating fan connected to o EEA649II / EEB649II o EFA649II / EFB649II wall mounted panel.	€ 610,00
FAWI06D01II-0P00	SWI 600	Modulation fan speed. DC Inverter. On board electronic control with PID full modulating fan connected to o EEA649II / EEB649II o EFA649II / EFB649II wall mounted panel.	€ 680,00
FAWI08D01II -0P00	SWI 800	Modulation fan speed. DC Inverter. On board electronic control with PID full modulating fan connected to o EEA649II / EEB649II o EFA649II / EFB649II wall mounted panel.	€ 770,00
For connection with remote thermostat			
FAWI04D01II-0T00	SWI 400	Fixed fan speed. DC Inverter. On board electronic control for connection with standard 4 fixed speed wall thermostats.	€ 610,00
FAWI06D01II-0T00	SWI 600	Fixed fan speed. DC Inverter. On board electronic control for connection with standard 4 fixed speed wall thermostats.	€ 680,00
FAWI08D01II -0T00	SWI 800	Fixed fan speed. DC Inverter. On board electronic control for connection with standard 4 fixed speed wall thermostats.	€ 770,00
For connection with 0-10 V			
FAWI04D01II-0V00	SWI 400	Modulation fan speed. DC Inverter. On board electronic control with 0-10V fan speed signal input.	€ 610,00
FAWI06D01II-0V00	SWI 600	Modulation fan speed. DC Inverter. On board electronic control with 0-10V fan speed signal input.	€ 680,00
FAWI08D01II-0V00	SWI 800	Modulation fan speed. DC Inverter. On board electronic control with 0-10V fan speed signal input.	€ 770,00

Prices are for products without accessories (control panel, valves, etc.). 2-way or 3-way water valves are mandatory for the correct operation of the unit.

Upon request, the fan coils can be supplied with some factory-mounted accessories (see notes in the Accessories paragraphs) without any additional charge for assembly

SWI models are produced with RIGHT hydraulic connection: for versions with LEFT hydraulic connections (available on all models) the seventh letter of the code is S (specify in the order). To the total price must be added the article BB0646II, i.e. the attachment shifting kit, and can only be mounted at the factory

Filomuro Built in accessory



EEA649II

SMART TOUCH wall control panel with thermostat and room probe. Black colour

€ 140,00 **NEW**

EEB649II

SMART TOUCH wall control panel with thermostat and room probe. White colour

€ 140,00 **NEW**



EFA649II

SMART TOUCH electronic wall control panel with thermostat and room probe with integrated WiFi module, InnovAPP. Black colour

€ 175,00 **NEW**

EFB649II

SMART TOUCH electronic wall control panel with thermostat and room probe with integrated WiFi module, InnovAPP. White colour

€ 175,00 **NEW**



B3V151II

Wall mounted control with thermostat, summer/winter and speed selectors, to be coupled with 4 speed units

€ 150,00



B3V152II

Concealed control with thermostat, summer/winter and speed selectors, to be coupled with 4 speed units

€ 190,00

BUTLER: codes, accessories and price list described in the appropriate section

NEW

BB0646II (1)

LEFT hydraulic connections configuration (motor connection cable for LEFT hydraulic connections)

€ 30,00

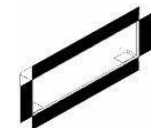

L01045II

Framework for fully aligned with the wall installation, SWI 400

€ 160,00

L01046II

Framework for fully aligned with the wall installation, SWI 600

€ 175,00

L01047II

Framework for fully aligned with the wall installation, SWI 800

€ 210,00

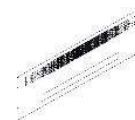

LC1092II

Fully aligned with the wall cover panel, SWI 400

€ 125,00

LC1093II

Fully aligned with the wall cover panel, SWI 600

€ 145,00

LC1094II

Fully aligned with the wall cover panel, SWI 800

€ 165,00

AI0200II

Couple of EUROKONUS adapters for 1/2" female connection (male fittings)

€ 22,00

AI0201II

Couple of EUROKONUS adapters for 3/4" female connection (male fittings)

€ 22,00

AI0203II

90° bended EUROKONUS connector

€ 23,00

AI0501II

Distancer kit (1 piece).

€ 23,00

AI0612II

Adaptors for flat ring

€ 12,00

I20686II (1)

2 way valve group with manual closure

€ 95,00

V20687II (1)

2 way valve group (water inlet valve, shut off valve and electro thermal motor)

€ 155,00

V30688II (1)

3 way valve group (with inlet 3 way valve, shut off valve, and electro thermal motor)

€ 190,00

(1) Accessories can be installed and tested at the factory

*Niniejsza oferta handlowa nie stanowi oferty w rozumieniu przepisów Kodeksu Cywilnego oraz innych właściwych przepisów.

Price List 2022 - rev.00



Filoterra DC Inverter, the trench installation fancoil

FAWF04DC1II-0P00	SLF 400	Floor installation fancoil with electronic modulating control onboard to be connected to remote wall control	610,00 €
FAWF04DC1II-0L00	SLF 400	Floor installation fancoil with electronic control onboard to be connected to standard 4 speed wall thermostats	610,00 €
FAWF04DC1II-0J00	SLF 400	Floor installation fancoil with electronic control onboard for 0-10 V connection	610,00 €
FAWF06DC1II-0P00	SLF 600	Floor installation fancoil with electronic modulating control onboard to be connected to remote wall control	680,00 €
FAWF06DC1II-0L00	SLF 600	Floor installation fancoil with electronic control onboard to be connected to standard 4 speed wall thermostats	680,00 €
FAWF06DC1II-0J00	SLF 600	Floor installation fancoil with electronic control onboard for 0-10 V connection	680,00 €
FAWF08DC1II-0P00	SLF 800	Floor installation fancoil with electronic modulating control onboard to be connected to remote wall control	770,00 €
FAWF08DC1II-0L00	SLF 800	Floor installation fancoil with electronic control onboard to be connected to standard 4 speed wall thermostats	770,00 €
FAWF08DC1II-0J00	SLF 800	Floor installation fancoil with electronic control onboard for 0-10 V connection	770,00 €

Electronic controls for wall control

EEA649II	SMART TOUCH electronic wall control panel with thermostat and room probe (to be coupled from 1 to max 30 ESE645), black colour	€ 140,00	NEW
EEB649II	SMART TOUCH electronic wall control panel with thermostat and room probe (to be coupled from 1 to max 30 ESE645), white colour	€ 140,00	NEW
EFA649II	SMART TOUCH electronic wall control panel with thermostat and room probe (to be coupled from 1 to max 30 ESE645), with WiFi module, black colour	€ 175,00	NEW
EFB649II	SMART TOUCH electronic wall control panel with thermostat and room probe (to be coupled from 1 to max 30 ESE645), with WiFi module, white colour	€ 175,00	NEW

Standard controls for wall control



B3V151II	Wall control with thermostat, summer/winter selector and speed selector in connection with B4V642II	€ 165,00
B3V152II	Wall flush-mounted control with thermostat, summer/winter selector and speed selector in connection with B4V642II	€ 205,00

Network Controls

BB0646II	BUTLER: codes, accessories and price list described in the appropriate section Configuration of hydraulic connections on the left (motor connection cable for moving hydraulic connections)	€ 30,00	NEW
----------	--	---------	------------



Metal casing for FiloTerra fancoils

CODE

L00749II
L00750II
L00751II

DESCRIPTION

Sheet metal casing for SLF 400 units
Sheet metal casing for SLF 600 units
Sheet metal casing for SLF 800 units

PRICE

€ 150,00
€ 165,00
€ 200,00

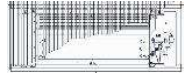

Cover grills

CODE

DR0752II
DR0753II
DR0754II

DESCRIPTION

Cover aluminum grill floor mounted version for SLF 400 units
Cover air flow vent aluminum grill floor mounted version for SLF 600 units
Cover air flow vent aluminum grill floor mounted version for SLF 800 units

PRICE

€ 505,00
€ 630,00
€ 755,00

Hydraulic groups

CODE

V20661II
V30662II
I20705II
AI0200II
AI0201II
AI0203II
AI0501II
AI0612II

DESCRIPTION

2 way valve group (water inlet valve, shut off valve and electro thermal motor) (*)
3 way valve group (water inlet valve, shut off valve and electro thermal motor)(*)
2 way valve group with manual closure (*)
Couple of EUROKONUS adapters for 1\2" female connection (male fittings)
Couple of EUROKONUS adapters for 3/4" female connection (male fittings)
90° bended EUROKONUS connector
Distancer kit (1 piece)
Adaptors for flat ring

PRICE

€ 230,00
€ 250,00
€ 75,00
€ 22,00
€ 22,00
€ 23,00
€ 23,00
€ 12,00

(*) Accessories that can be factory mounted without any extra cost

*Niniejsza oferta handlowa nie stanowi oferty w rozumieniu przepisów Kodeksu Cywilnego oraz innych właściwych przepisów.

Price List 2022 - rev.00



DUCTO

Horizontal false ceiling installation fan coil unit with centrifugal fans.

For connection with remote keyboard

FASN04R01II-0P00	SLC 400	Modulation fan speed. DC Inverter. On board electronic control with PID full modulating fan connected to EDA/EDB749 - EWG/EWW749 (wall mounted panel).	€ 965,00
FASN06R01II-0P00	SLC 600	Modulation fan speed. DC Inverter. On board electronic control with PID full modulating fan connected to EDA/EDB749 - EWG/EWW749 (wall mounted panel).	€ 1 080,00
FASN08R01II-0P00	SLC 800	Modulation fan speed. DC Inverter. On board electronic control with PID full modulating fan connected to EDA/EDB749 - EWG/EWW749 (wall mounted panel).	€ 1 305,00
FASN10R01II-0P00	SLC 1000	Modulation fan speed. DC Inverter. On board electronic control with PID full modulating fan connected to EDA/EDB749 - EWG/EWW749 (wall mounted panel).	€ 1 420,00
FASN12R01II-0P00	SLC 1200	Modulating speed. DC Inverter. With electronic board with continuous modulation for connection to wall control EEA/EEB749 - EFA/EFB749 (to be ordered separately).	€ 1 800,00 NEW

For connection with 0-10 V

FASN04R01II-0J00	SLC 400	Modulation fan speed. DC Inverter. With 0-10V fanspeed signal input.	€ 770,00
FASN06R01II-0J00	SLC 600	Modulation fan speed. DC Inverter. With 0-10V fanspeed signal input.	€ 885,00
FASN08R01II-0J00	SLC 800	Modulation fan speed. DC Inverter. With 0-10V fanspeed signal input.	€ 1 135,00
FASN10R01II-0J00	SLC 1000	Modulation fan speed. DC Inverter. With 0-10V fanspeed signal input.	€ 1 310,00
FASN12R01II-0J00	SLC 1200	Modulating speed. DC Inverter. With electronic board for 0-10 V interface.	€ 1 450,00 NEW

- For versions with hydraulic connections on the left (available on all models) the seventh letter of the code will be "O" (specify when ordering).

ACCESSORIES SUPPLIED SEPARATELY



EEA649II	SMART TOUCH electronic wall control panel with thermostat and room probe (to be coupled from 1 to max 30 ESE645), black colour	€ 140,00	NEW
EEB649II	SMART TOUCH electronic wall control panel with thermostat and room probe (to be coupled from 1 to max 30 ESE645), white colour	€ 140,00	NEW
EFA649II	SMART TOUCH electronic wall control panel with thermostat and room probe (to be coupled from 1 to max 30 ESE645), with WiFi module, black colour	€ 175,00	NEW
EFB649II	SMART TOUCH electronic wall control panel with thermostat and room probe (to be coupled from 1 to max 30 ESE645), with WiFi module, white colour	€ 175,00	NEW
	BUTLER: codes, accessories and price list described in the appropriate section		NEW
GR1100II	Supply air outlet plate with 2 circular connections DN160 mm,SLC 400	€ 50,00	
GR1101II	Supply air outlet plate with 3 circular connections DN160 mm, SLC 600	€ 65,00	
GR1102II	Supply air outlet plate with 4 circular connections DN160 mm,SLC 800	€ 85,00	
GR1103II	Supply air outlet plate with 6 circular connections DN160 mm,SLC 1000	€ 110,00	
GR1104II	Intake air plate with 2 circular connections DN160 mm,SLC 400	€ 150,00	
GR1105II	Intake air plate with 3 circular connections DN160 mm,SLC 600	€ 155,00	
GR1106II	Intake air plate with 4 circular connections DN160 mm, SLC 800	€ 200,00	
GR1107II	Intake air plate with 6 circular connections DN160 mm, SLC 1000	€ 210,00	
GR1200II	Take-up plate with 7 circular inlets, DN 160 mm, SLC 1200	€ 235,00	NEW
GR1201II	Flow plate with 7 circular inlets, DN 160 mm, SLC 1200	€ 130,00	NEW
I20205II	Manual 2-way valve unit	€ 65,00	
V20139II	2-way valve unit (inlet valve and lockshield) with thermoelectric motor	€ 145,00	NEW
V30361II	3-way diverter valve unit with thermoelectric motor (complete with 3-way inlet valve and lockshield)	€ 180,00	NEW
GR1119II	Aluminium outlet grille with double row of adjustable blades, white.	€ 165,00	NEW
GR1120II	Aluminium suction grid with removable filter, white	€ 165,00	NEW
GR0945II	Alufonic insulated hose DN 160 mm. Supplied in 10 m reels, at €/m	€ 15,00	NEW
GR1118II	Insulated plenum for supply/return with 2 inlets DN 160 mm, 1 plug DN 160 mm and grid connection.	€ 110,00	NEW
GR1226II	Replacement filter kit, SLC 400	€ 30,00	NEW
GR1227II	Replacement filter kit, SLC 600	€ 37,00	NEW
GR1228II	Replacement filter kit, SLC 800	€ 52,00	NEW
GR1229II	Replacement filter kit, SLC 1000	€ 68,00	NEW
GR1230II	Replacement filter kit, SLC 1200	€ 72,00	NEW

DUCTO MULTI

Horizontal ceiling-mounted or concealed fan coil unit

For connection with remote controls

FASQ06R01II-0P00	SLC+ 600	Modulating speed. DC Inverter. With electronic board with continuous modulation for connection to wall control EEA/EEB749 - EFA/EFB749 (to be ordered separately).	€ 1 450,00	NEW
FASQ08R01II-0P00	SLC+ 800	Modulating speed. DC Inverter. With electronic board with continuous modulation for connection to wall control EEA/EEB749 - EFA/EFB749 (to be ordered separately).	€ 2 180,00	NEW
FASQ10R01II-0P00	SLC+ 1000	Modulating speed. DC Inverter. With electronic board with continuous modulation for connection to wall control EEA/EEB749 - EFA/EFB749 (to be ordered separately).	€ 2 450,00	NEW
FASQ12R01II-0P00	SLC+ 1200	Modulating speed. DC Inverter. With electronic board with continuous modulation for connection to wall control EEA/EEB749 - EFA/EFB749 (to be ordered separately).	€ 3 380,00	NEW

For connection 0-10 V

FASQ06R01II-0J00	SLC+ 600	Modulating speed. DC Inverter. With electronic board for 0-10 V interface.	€ 1 240,00	NEW
FASQ08R01II-0J00	SLC+ 800	Modulating speed. DC Inverter. With electronic board for 0-10 V interface.	€ 1 850,00	NEW
FASQ10R01II-0J00	SLC+ 1000	Modulating speed. DC Inverter. With electronic board for 0-10 V interface.	€ 2 050,00	NEW
FASQ12R01II-0J00	SLC+ 1200	Modulating speed. DC Inverter. With electronic board for 0-10 V interface.	€ 2 900,00	NEW

- For versions with hydraulic connections on the left (available on all models) the seventh letter of the code will be "O" (specify when ordering).

Accessories supplied separately



EEA649II

SMART TOUCH electronic wall control panel with thermostat and room probe (to be coupled from 1 to max 30 ESE645), black colour

€ 140,00 **NEW**

EEB649II

SMART TOUCH electronic wall control panel with thermostat and room probe (to be coupled from 1 to max 30 ESE645), white colour

€ 140,00 **NEW**



EFA649II

SMART TOUCH electronic wall control panel with thermostat and room probe (to be coupled from 1 to max 30 ESE645), with WiFi module, black colour

€ 175,00 **NEW**

EFB649II

SMART TOUCH electronic wall control panel with thermostat and room probe (to be coupled from 1 to max 30 ESE645), with WiFi module, white colour

€ 175,00 **NEW**

BUTLER: codes, accessories and price list described in the appropriate section

NEW

GR1233II

Take-up plate 2 circular inlets, Dn 160 mm, SLC+ 600

€ 155,00 **NEW**

GR1234II

Take-up plate 3 circular inlets, Dn 160 mm, SLC+ 800

€ 200,00 **NEW**

GR1235II

Take-up plate 4 circular inlets, Dn 160 mm, SLC+ 1000

€ 210,00 **NEW**

GR1236II

Take-up plate 5 circular inlets, Dn 160 mm, SLC+ 1200

€ 235,00 **NEW**

GR1227II

Replacement filter kit, SLC+ 600

€ 37,00 **NEW**

GR1228II

Replacement filter kit, SLC+ 800

€ 52,00 **NEW**

GR1229II

Replacement filter kit, SLC+ 1000

€ 68,00 **NEW**

GR1230II

Replacement filter kit, SLC+ 1200

€ 72,00 **NEW**

V20139II

2-way valve unit (inlet valve and lockshield) with thermoelectric motor

€ 145,00 **NEW**

V30361II

3-way diverter valve unit with thermoelectric motor (complete with 3-way inlet valve and lockshield)

€ 180,00 **NEW**

I20205II

Manual 2-way valve unit

€ 65,00 **NEW**

GR1119II

Aluminium delivery grille with double row of adjustable fins, white. Dimensions: 450x225 mm

€ 165,00 **NEW**

GR1120II

Aluminium suction grid with removable filter, white. Dimensions 450x 225 mm

€ 165,00 **NEW**

GR0945II

Alufonic insulated hose DN 160 mm. Supplied in 10 m reels, price in €/m

€ 15,00 **NEW**

GR1118II

Insulated plenum for supply/return with 2 inlets DN 160 mm, 1 plug DN 160 and grid connection. Dimensions: 450x175x175 mm

€ 110,00 **NEW**

*Niniejsza oferta handlowa nie stanowi oferty w rozumieniu przepisów Kodeksu Cywilnego oraz innych właściwych przepisów.

Price List 2022 - rev.00



..2.0 H2O water to air monobloc aircon

CODE	MODEL	DESCRIPTION	PRICE
CZMW15IC3II	..2.0 H2O 15 HP DC Inverter	Monobloc water to air aircon - DC INVERTER DUAL POWER	€ 2 980,00

"..2.0 H2O" Accessories

CODE	DESCRIPTION	PRICE
ECA031II	SMART TOUCH electronic wall control panel with thermostat and room probe and WIFI, black colour	€ 175,00
ECB031II	SMART TOUCH electronic wall control panel with thermostat and room probe and WIFI, white colour	€ 175,00
ECA032II	SMART TOUCH electronic wall control panel with thermostat and room probe with integrated Mpdbus port (supplied with 8m connection cable), black colour	€ 175,00
ECB032II	SMART TOUCH electronic wall control panel with thermostat and room probe with integrated Mpdbus port (supplied with 8m connection cable), white colour	€ 175,00
GB1018II	Water source modulating valve kit	€ 440,00
GB0737II	Cover for lower side of ..2.0 (in case of high wall installation)	€ 65,00
GB0742II	Kit for installation on glass walls	€ 200,00

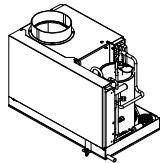

Water-Air AIR COMPACT

CODE	MODEL	DESCRIPTION	PRICE
CONR08I03II	4M (single phase)	Packaged water to air heat pump with DC inverter compressor, size 4M	€ 3 650,00
CONR12I03II	6M (single phase)	Packaged water to air heat pump with DC inverter compressor, size 6M	€ 4 300,00

Accessories

CODE	DESCRIPTION	PRICE
ECA031II	SMART TOUCH electronic wall control panel with thermostat and room probe and WIFI, black colour	€ 175,00
ECB031II	SMART TOUCH electronic wall control panel with thermostat and room probe and WIFI, white colour	€ 175,00



Chiller DC Inverter

Monobloc DC Inverter chiller for indoor installation

CODE	MODEL	DESCRIPTION	PRICE
REC105IC3II	in.CH 5M (single phase)	Water chiller DC Inverter with evaporative condensation for indoor installation	€ 9 000,00
REC107IC3II	in.CH 7M (single phase)	Water chiller DC Inverter with evaporative condensation for indoor installation	€ 10 200,00
REC110IC3II	in.CH 10M (single phase)	Water chiller DC Inverter with evaporative condensation for indoor installation	€ 11 300,00
REC110IC5II	in.CH 10T (three phase)	Water chiller DC Inverter with evaporative condensation for indoor installation	€ 11 300,00

Accessories for in.CH Chillers

CODE	DESCRIPTION	PRICE
AI0334II	Flexible ducts for wall installation	€ 140,00

Price List 2022 - rev.00

BUTLER- Web server for plant control and remote management.



CODICE	MODELLO	DESCRIZIONE	PREZZO
ESW736II	BUTLER PRO TOUCH	Control board with 10" display	€ 1 380,00
ESW737II	BUTLER PRO	Control unit without display to be installed in the electrical cabinet	€ 900,00

Accessori BUTLER

L01063II		Pre-installation box - full aligned with the wall	€ 60,00
GR1128II		12 V DC feeder	€ 45,00
EG1028II		MZS, single zone module	€ 85,00
EP0642II		Energy monitor for monophasic heat pumps	€ 165,00
EP0643II		Energy monitor for tri-phase heat pumps	€ 335,00
EEA649II		SMART TOUCH wall-mounted control panel with thermostat and room temperature and relative humidity probe. BLACK colour.	€ 140,00 NEW
EEB649II		SMART TOUCH wall-mounted control panel with thermostat and room temperature and relative humidity probe. WHITE colour.	€ 140,00 NEW

*(1) The installation box is mandatory for the installation of BUTLER PRO TOUCH

*(2) The power supply is mandatory unless the installer provides a separate 12-24 VDC power supply of at least 5 V.

*Niniejsza oferta handlowa nie stanowi oferty w rozumieniu przepisów Kodeksu Cywilnego oraz innych właściwych przepisów.

Price List 2022 - rev.00



BEE - Building Energy Efficiency BEE The Heat Recovery System

CODE	MODEL	DESCRIPTION	PRICE
HR4006I00II	BEE 600	Heat Recovery System	€ 800,00
HR4013I00II	BEE 1300	Heat Recovery System	€ 1 000,00

Accessories BEE

GB0757II		Inspection cap for heat recovery system	€ 40,00
----------	--	---	---------

*Niniejsza oferta handlowa nie stanowi oferty w rozumieniu przepisów Kodeksu Cywilnego oraz innych właściwych przepisów.