

User's manual
(Translation of original
language)

EN



N421070A - Rev.03 - 06/2025

Innova Butler / Innova

Remote control app compatible with ..2.0,
WLHP and M7 commands

First of all, we would like to thank you for having chosen a device of our production.

We are sure you will be happy with it because it represents the state of the art in the technology of home air conditioning.

By following the suggestions contained in this manual, the product you have purchased will provide trouble free operation, giving you optimum room temperatures with minimum energy costs.

INNOVA S.r.l.

Conformity

Refer to the Installation Manual of the paired unit.

Markings



TABLE OF CONTENTS

1. General information	4
1.1 About the manual	4
1.2 Disposal	5
1.3 General warnings	5
2. Installation	6
2.1 Description	6
2.2 Configurable products.	6
2.3 Downloading the application	7
3. Settings.	8
3.1 Preliminary warnings	8
3.2 Access to the App.	8
3.3 Add a home	10
3.4 Configuration	11
3.5 To invite someone	13
4. Basic settings	14
4.1 Interface	14
4.2 Profile	15
4.3 Request for assistance	16
4.4 Calendaring	16
4.5 New device	20
5. General settings	21
5.1 General settings	21
5.2 Manage homes	21
5.3 Manage rooms	26
6. Device specific commands.	30
6.1 Device specific commands	30
7. On, Off, and Reset of the Wi-Fi network.	33
7.1 Onboard commands of an air conditioner.	33
7.2 Onboard command EWA844 - EWA044	33
7.3 Onboard command EWF944	34
7.4 Wall control EFB749	34
8. Troubleshooting	35
8.1 Error signals.	35
8.2 Troubleshooting	35

1. GENERAL INFORMATION

1.1 About the manual

This manual was written to provide all the explanations for the correct management of the device.

 This instruction manual forms an integral part of the device and therefore must be carefully preserved and must ALWAYS travel with it, even if you transfer the device to another owner or relocate it to other premises. If the manual gets damaged or lost, download a copy from the website.

 Read this manual carefully before proceeding with any operation and follow the instructions in the individual chapters.

 The Manufacturer accepts no liability for damages to persons or property caused by failure to follow the instructions in this manual.

 This document is restricted in use to the terms of the law and may not be copied or transferred to third parties without the express authorisation of the Manufacturer.

1.1.1 Editorial pictograms

The pictograms in the next chapter provide the necessary information for correct and safe use of the machine in a rapid and unmistakable way.

Related to security

High risk warning (bold text)

- The operation described above presents a risk of serious physical injury, fatality, major damage to the device and/or to the environment if not carried out in compliance with safety regulations.

Low risk warning (plain text)

- The operation described above presents a risk of minor physical injury or minor damage to the device and/or to the environment if not carried out in compliance with safety regulations.

Prohibition (plain text)

- Refers to prohibited actions.

Important information (bold text)

- This indicates important information that must be taken into account during the operations.

In the texts

- procedures
- lists

In the control panels

- actions required
- Expected responses following an action.*

In the figures

1 The numbers indicate the individual components.

A The capital letters indicate component assemblies.

 The white numbers in black marks indicate a series of actions to be carried out in sequence.

 The black letter in white identifies an image when there are several images in the same figure.

1.1.2 Pictograms on the product

Symbols are used in some parts of the device:

Related to security



Read instruction manual

Read the instructions carefully before performing any work on the device.



Instruction manual

Read the information available in the technical documentation of the device.



Caution: electrical danger

- The concerned personnel is informed to the presence of electricity and the risk of suffering an electric shock.

1.1.3 Recipients

User

Non-expert person capable of operating the product in safe conditions for people, for the product itself and the environment, interpreting an elementary diagnostic of faults and abnormal operating conditions, carrying out simple adjustment, checking and maintenance operations.

Installer

Expert person qualified to position and connect (hydraulically, electrically, etc.) the unit to the plant; this person is responsible for handling and correct installation according to the instructions provided in this manual and the national standards currently in force.

Authorised Service Centre

Expert and qualified person authorised directly by the manufacturer to carry out all routine and supplementary maintenance operations, as well as every adjustment, check, repair and replacement of parts necessary during the life of the unit itself.

1.1.4 Manual organisation

The manual is divided into sections each dedicated to one or more target groups.

General information

It addresses all recipients.

It contains general information and important warnings that should be known before installing and using the device.

Installation

It addresses all recipients.

It contains information required for the installation of the mobile application.

Preliminary settings

It addresses all recipients.

It contains useful information for the control of the unit via the app for mobile and the use of main functions.

Basic settings

It addresses all recipients.

It contains useful information for the control of the unit via the app for mobile and the use of main functions.

General settings

It addresses all recipients.

It contains useful information for the control of the unit via the app for mobile and the use of main functions.

Device specific commands

It addresses all recipients.

It contains useful information for the control of the unit via the app for mobile and the use of main functions.

1.2 Disposal



The symbol on the product or packaging indicates that the product must not be treated as normal household waste, but must be taken to the appropriate collection point for recycling of used electrical and electronic equipment and batteries.

Proper disposal of this product avoids harm to humans and the environment and promotes the reuse of valuable raw materials.

For more detailed information about the recycling of this product, contact your local authority, your household waste disposal service or the shop where you purchased the product.

Illegal disposal of the product by the user involves the application of the administrative sanctions provided for by the regulations in force.

This provision is valid in the EU Member States.



This symbol might be used in combination with a chemical symbol.

In this case, it complies with the requirement set by the Directive for the chemical involved.

1.3 General warnings

- ⚠ This instruction is an integral part of the booklet of the device.
- ⚠ The manufacturer reserves the right to make changes to its models at any time to improve its product, without prejudice to the essential characteristics described in this manual. The manufacturer is not obliged to add such modifications to machines previously manufactured, already delivered, or under construction.
- ⚠ All repair or maintenance interventions must be performed by an Authorised Service Centre or by professionally qualified personnel as foreseen in this booklet. Do not modify or intervene on the device as this could create dangerous situations and the Manufacturer will not be responsible for any damage caused.

2. INSTALLATION

2.1 Description

Innova Butler / Innova is the application that allows you to manage the elements of your home system through your smartphone or tablet, directly from home or remotely. Through the application you can set commands to individual devices, rooms or directly to the whole house.

2.1.1 Main functions

- supervision and control via local or remote network
- customised summer and winter programming
- weekly time programming
- domestic hot water setting
- remote assistance

2.2 Configurable products

The devices that can be configured through the application are:

- air conditioners ..2.0
- WLHP heat pump terminals
- M7 series controls

The Innova Butler / Innova application can be used with:

Wall control

- EFB749

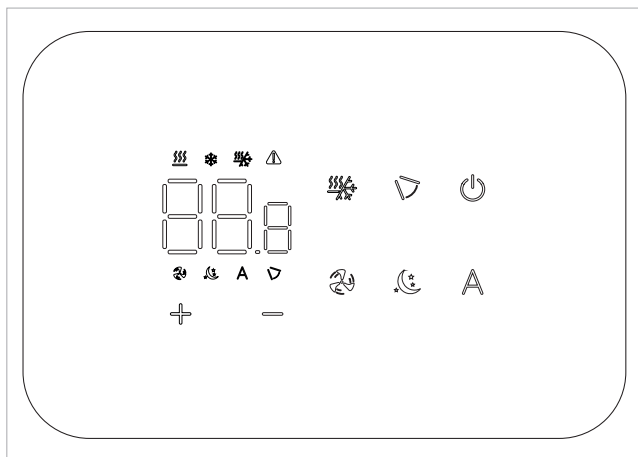

Controls on the device

- EWA844
- EWA044
- EWF944

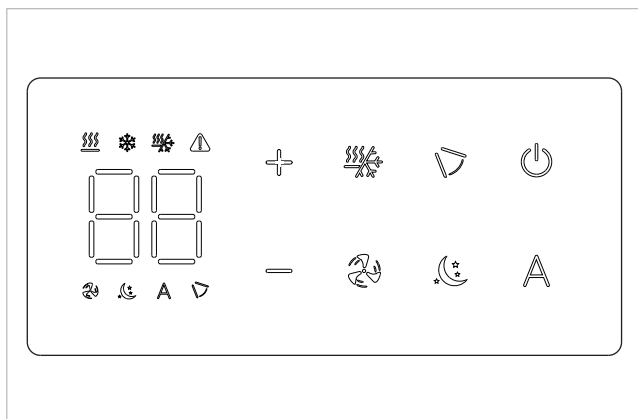

- on-board display unit air conditioners

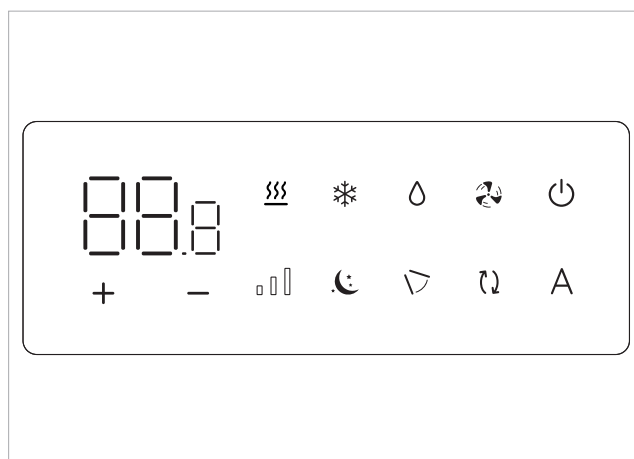

⚠ Individually configurable devices are those with a Wi-Fi connection. Directly connected devices cannot be managed individually by the application.

⚠ Devices with a Wi-Fi connection can only be configured using the app from your smartphone or tablet.

2.3 Downloading the application

2.3.1 Minimum requirements

In order to proceed with the download and installation of the application, some version requirements of the operating system of your smartphone are necessary.

- For Android: minimum version 9.0
- For iOS: minimum version 15.0
- Bluetooth: > 5.0

⚠ The devices are only able to connect to 2,4 GHz networks.

2.3.2 Android user - Innova

On your smartphone or tablet:

- ▶ connecting to Play Store
- ▶ search for the Innova application
- ▶ download and install the application

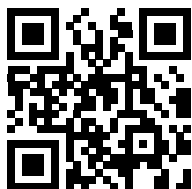

2.3.3 iOS user - Innova Butler

On your smartphone or tablet:

- ▶ connecting to the App Store
- ▶ search for the Innova Butler application
- ▶ download and install the application



3. SETTINGS

3.1 Preliminary warnings

- ⚠ Before starting to use the application make sure that:
- the device being configured is connected to the home network
 - in the case of devices with Wi-Fi connectivity, the signal reaches the device in a strong and stable manner

3.2 Access to the App

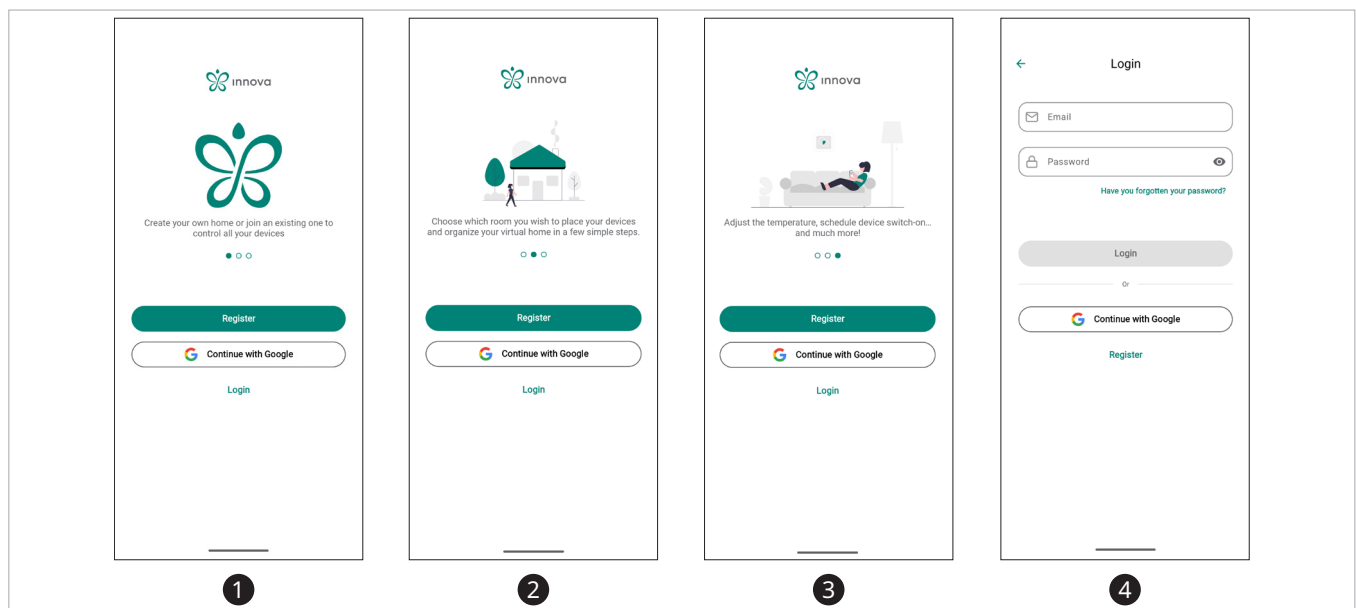

- ⚠ If you use the application for the first time, you will be asked to log in or register in order to continue.

To access

- ▶ open the application
 - ▶ log in or register
- When registration is complete, the add a home screen appears.*

3.2.1 Registration through Google account

Selecting Continue with Google will open a window in which you can login to the app using your Google account.

- ▶ enter your account credentials and password
- ▶ press next to continue

- ⚠ When accessing the application for the first time using the account indicated, user registration will be carried out automatically.

3.2.2 Registration by email

- ⚠ When accessing the application for the first time, it is necessary to register an account.

To register

- ▶ select registered
 - ▶ complete the fields
- If you fill in the form correctly, you will receive a notification of successful registration.*
- A warning message will appear if there are any errors in the compilation.*

- ⚠ It will be necessary to validate the e-mail.

- ⚠ When accessing the application for the first time using the account indicated, user registration will be carried out automatically.

If you are accessing with an already registered account, please login

- ▶ enter your account email and password
- ▶ press login

3.2.3 Registration through Apple account

Selecting Continue with Apple will open a window in which you can login to the app using your Apple account.

- ▶ enter your Apple ID and account password
- ▶ press the arrow to continue

⚠ When accessing the application for the first time using the account indicated, user registration will be carried out automatically.

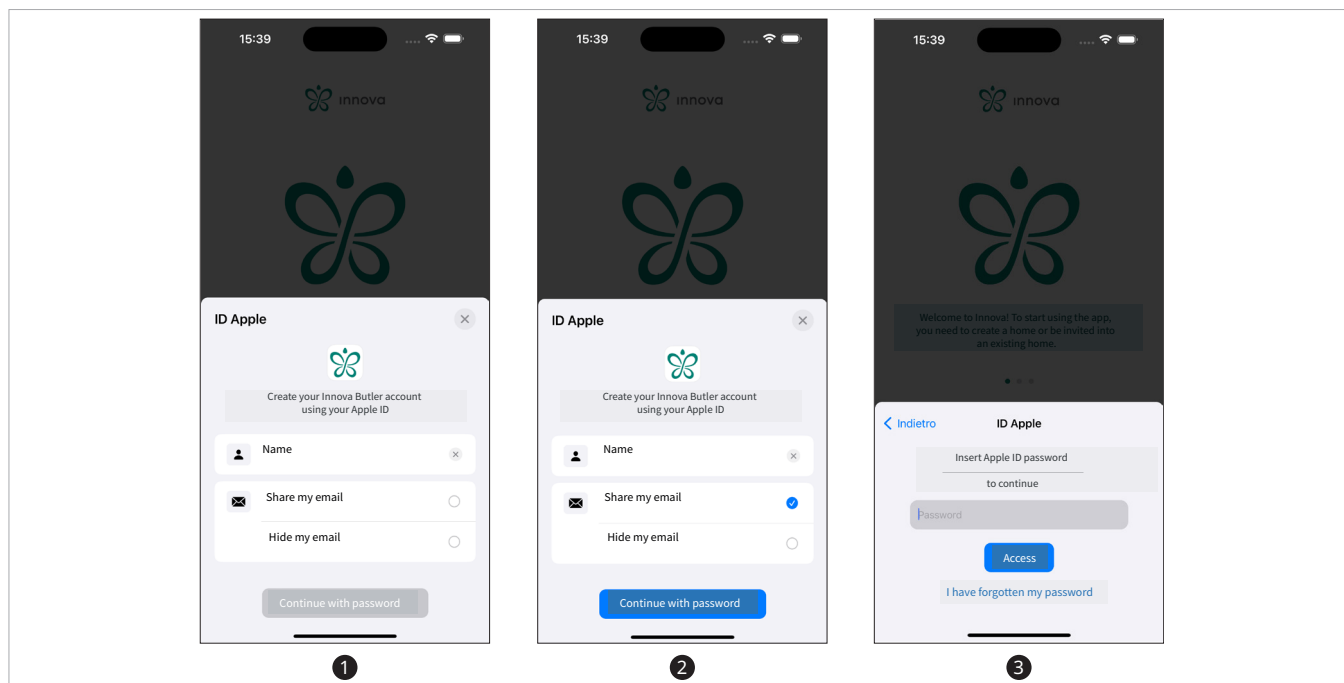

3.2.4 Privacy consents

Through the application, in the user area, you can check the privacy policy dedicated to the app.

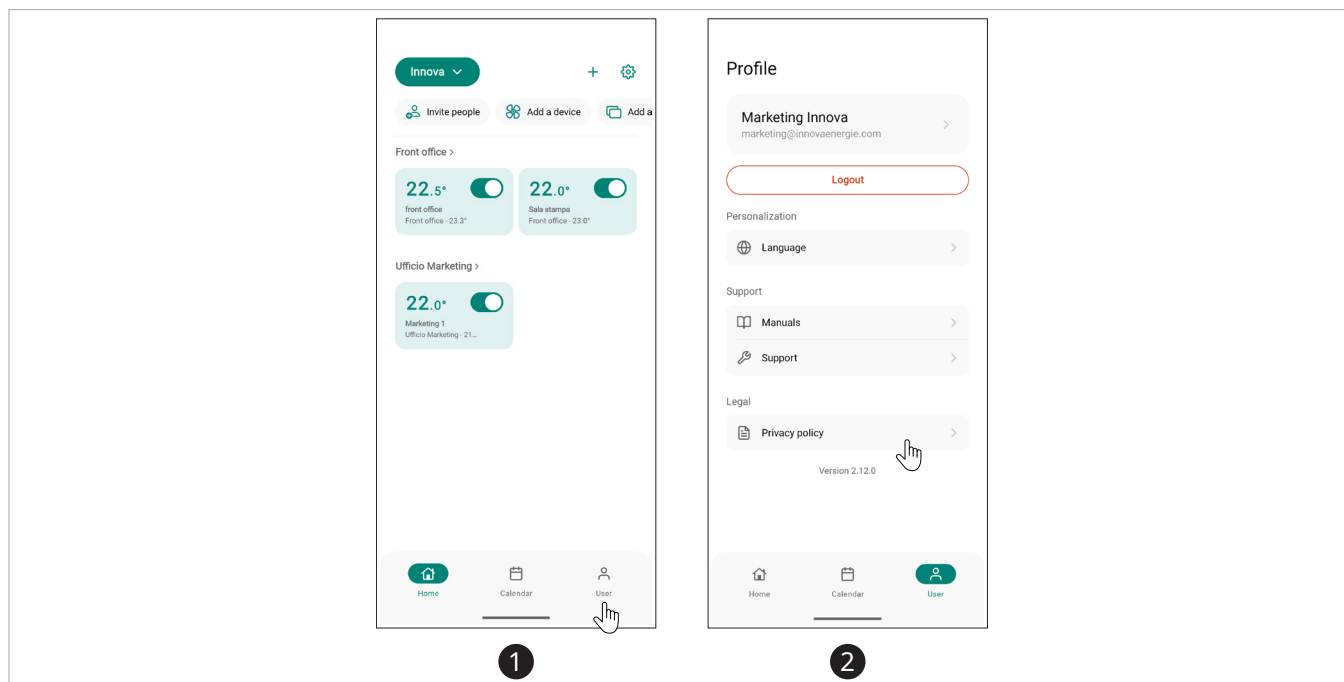

To see the privacy policy

- ▶ select user
- ▶ select Privacy policy
A page within the website opens.
- ▶ press privacy policy from the app
A page opens containing the information

3.3 Add a home

In order to set up a device, it is first necessary to create a home.

After registering, on the first login you will be asked to add a house.

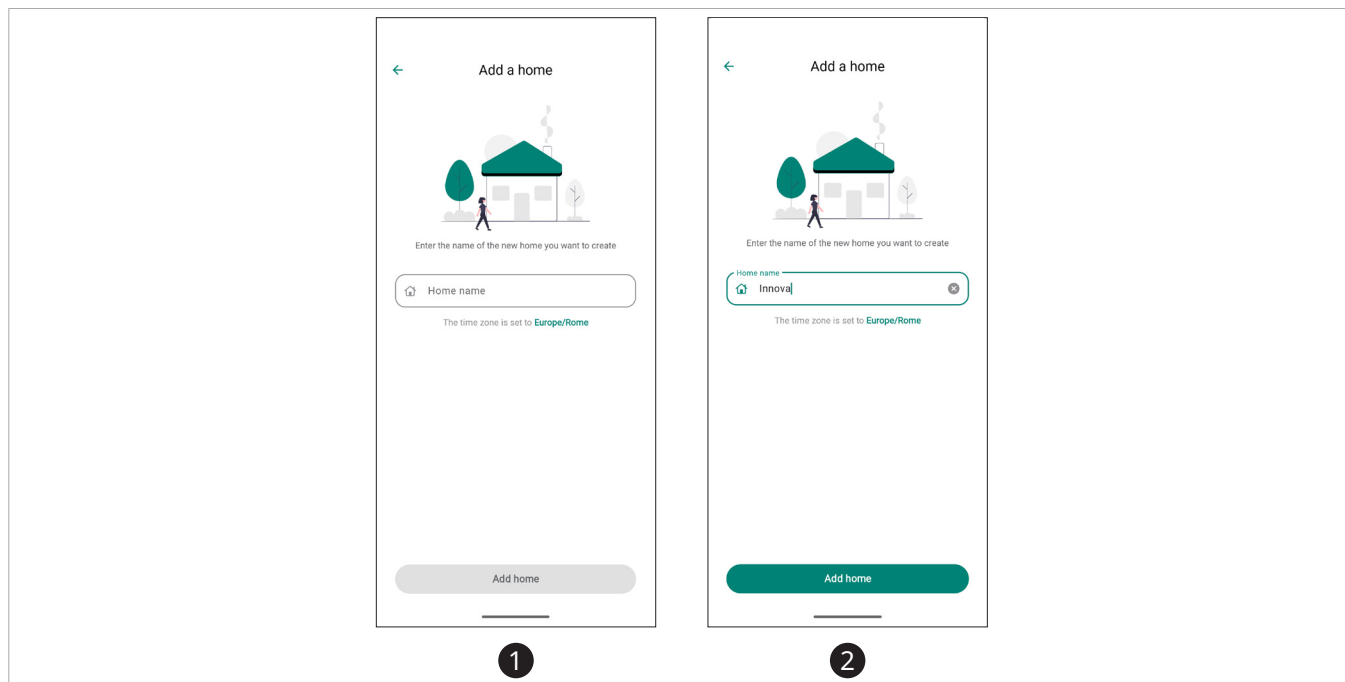

To add a home

- ▶ enter the name you want to give the home
 - ▶ select create home
- Your home has been created.*

3.4 Configuration

In order to manage and control your devices through the app, you need to configure them. The first time you access the app you will be asked to configure your device.

⚠ If there are several devices, they must be added and configured individually.

⚠ Switch on and configure one device at a time to avoid errors.

⚠ Switch off devices that are not being configured by switching them off or setting the Wi-Fi of the control connected to the device to OFF.

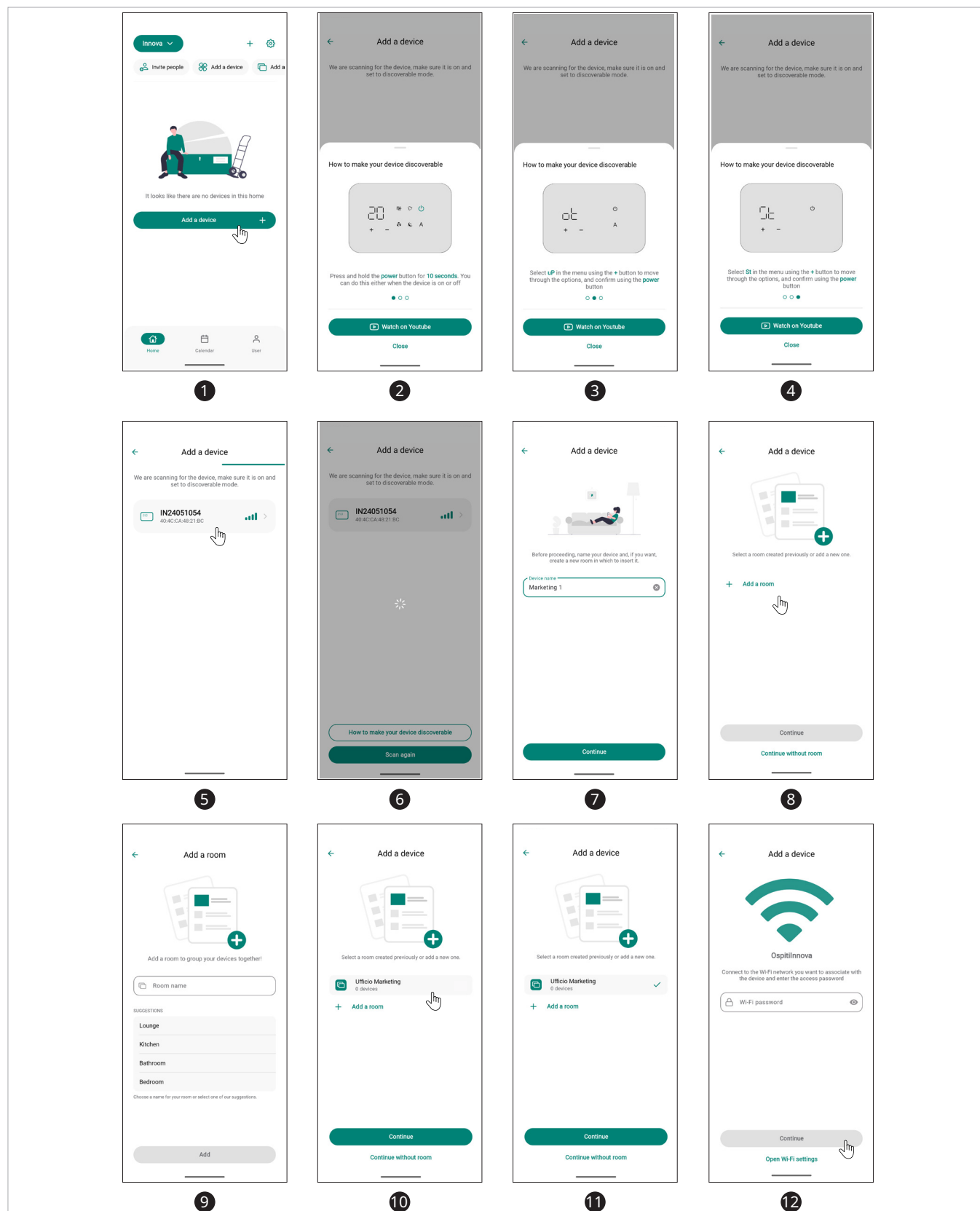

⚠ To proceed, it is necessary to allow access to the location.

To configure a device

- ▶ select add a device
- ▶ See the instructions for making your device detectable, or watch the video
- ▶ select close
A list appears with the available devices to be configured.
- ▶ select device
- ▶ enter the name you want to give the device
- ▶ select continue
- ▶ add the device to a room or continue without a room
- ▶ select continue
A screen appears where you need to enter your Wi-Fi network password.

- ▶ enter password
- ▶ select continue
The device is successfully added.

⚠ The device remains visible only for the first 15 minutes after being turned on, after which it is necessary to manually activate the configuration procedure or remove and restore power to the device.

⚠ If you are not connected to a network, you will be prompted to connect to a Wi-Fi network and enter the password to configure the device.

⚠ If the new device cannot be added, press retry and repeat the same operation.

⚠ Please refer to chapter "Manage rooms" *p. 26* for information about rooms.

⚠ For configuring a new device, refer to the chapter "New device" *p. 20*.

3.4.1 Device configuration

⚠ If, after selecting add a device, no device appears, it is necessary to perform the device search procedure.

To perform the search procedure for configuring the device

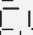
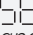
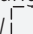
- ▶ access the basic menu (for instructions on accessing the basic menu, refer to the paragraph "On, Off, and Reset of the Wi-Fi network" *p. 33*)
- ▶ select 
- ▶ select  to disable pairing
- ▶ select  enable pairing
The change is confirmed by the appearance of the symbol .

⚠ To search for a unit, you need to be close to the unit.

⚠ After performing the search procedure, the device to be configured appears.

⚠ For more details, refer to the paragraph "On, Off, and Reset of the Wi-Fi network" *p. 33*.

⚠ Before configuring a device, it is necessary to check that the serial number appearing on the App matches the one on the device. To verify the serial number, refer to the "identification" paragraph in the device's installation manual.

3.5 To invite someone

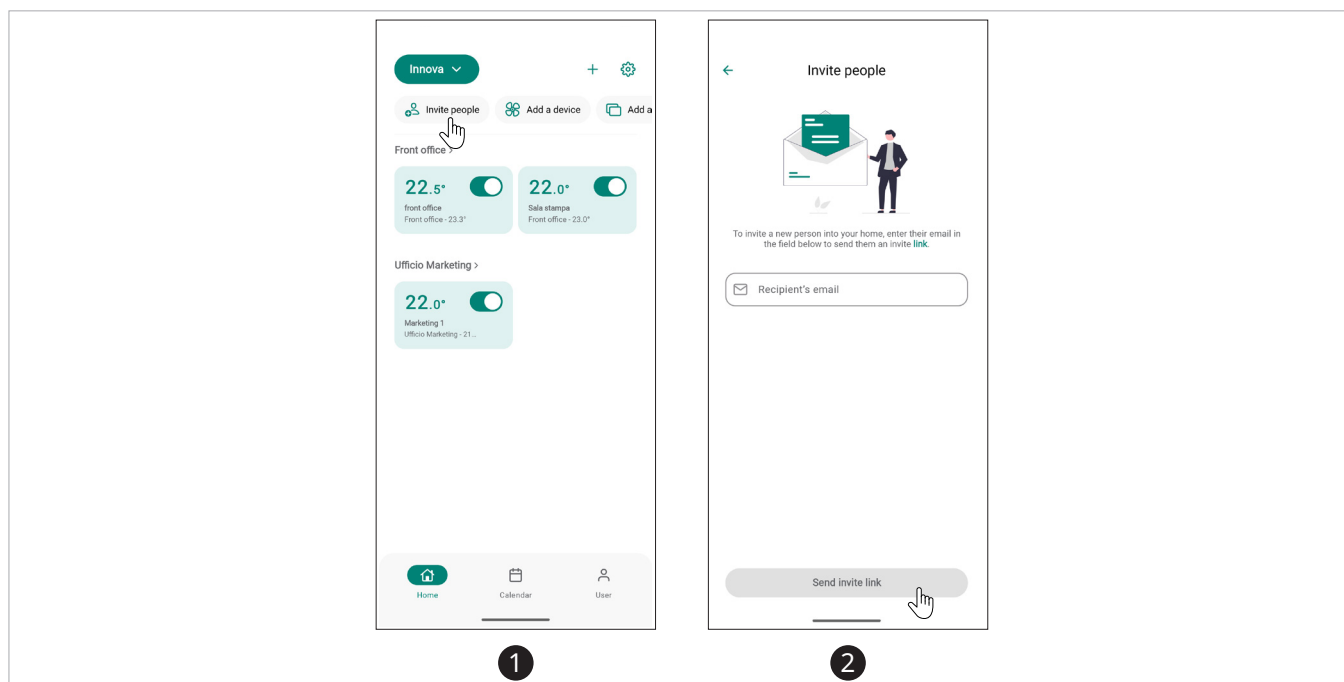

To invite someone into your home

- ▶ select invite people
 - ▶ enter the e-mail address of the person you wish to invite
 - ▶ select send invitation link
- A notice appears asking if you want to send the invitation.
The link is sent.*

- ⚠ The invitation remains pending until it is accepted.
- ⚠ To open the link, you must first install the App.
- ⚠ It is possible to revoke the invitation until it is accepted.

4. BASIC SETTINGS

4.1 Interface

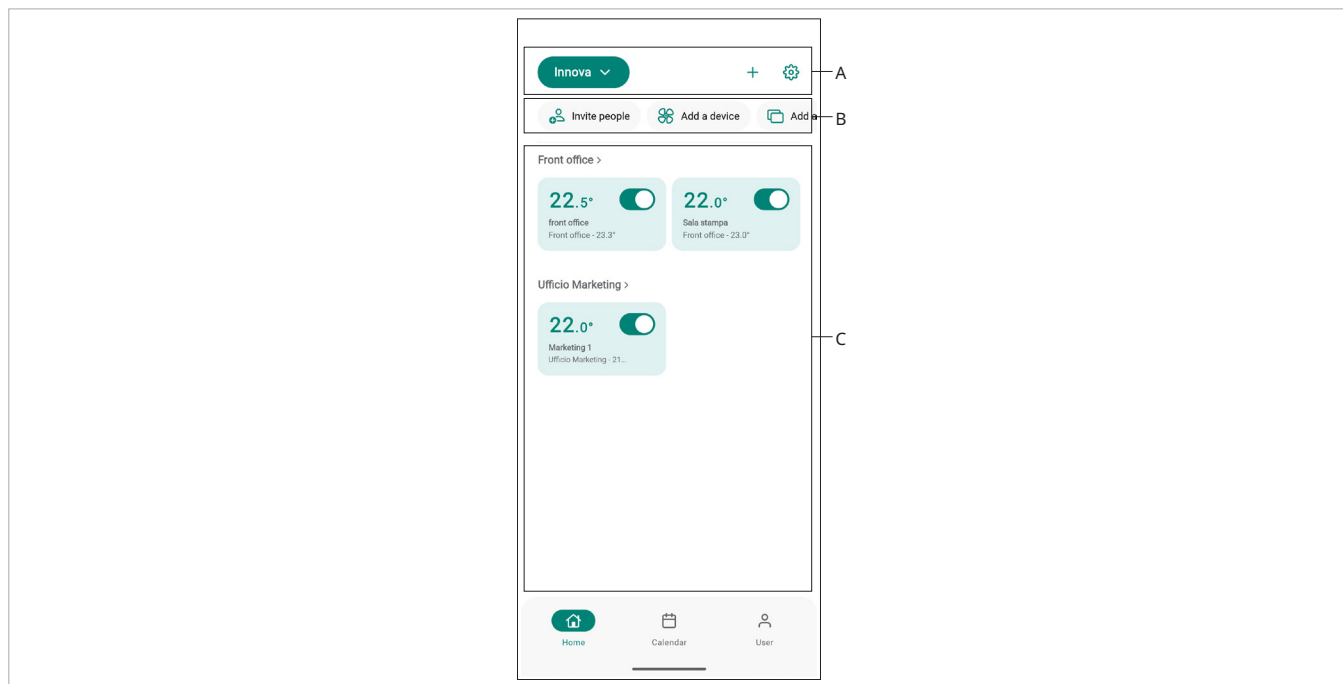

A: Navigation bar

- ▶ + Options for editing/adding devices, people, rooms, and houses
- ▶ ⚙ Device specific settings

B: Quick Controls

You can invite people, add a device or add a room.

C: Room and device management area

The rooms and the individual devices present in the rooms are displayed and managed.

4.2 Profile

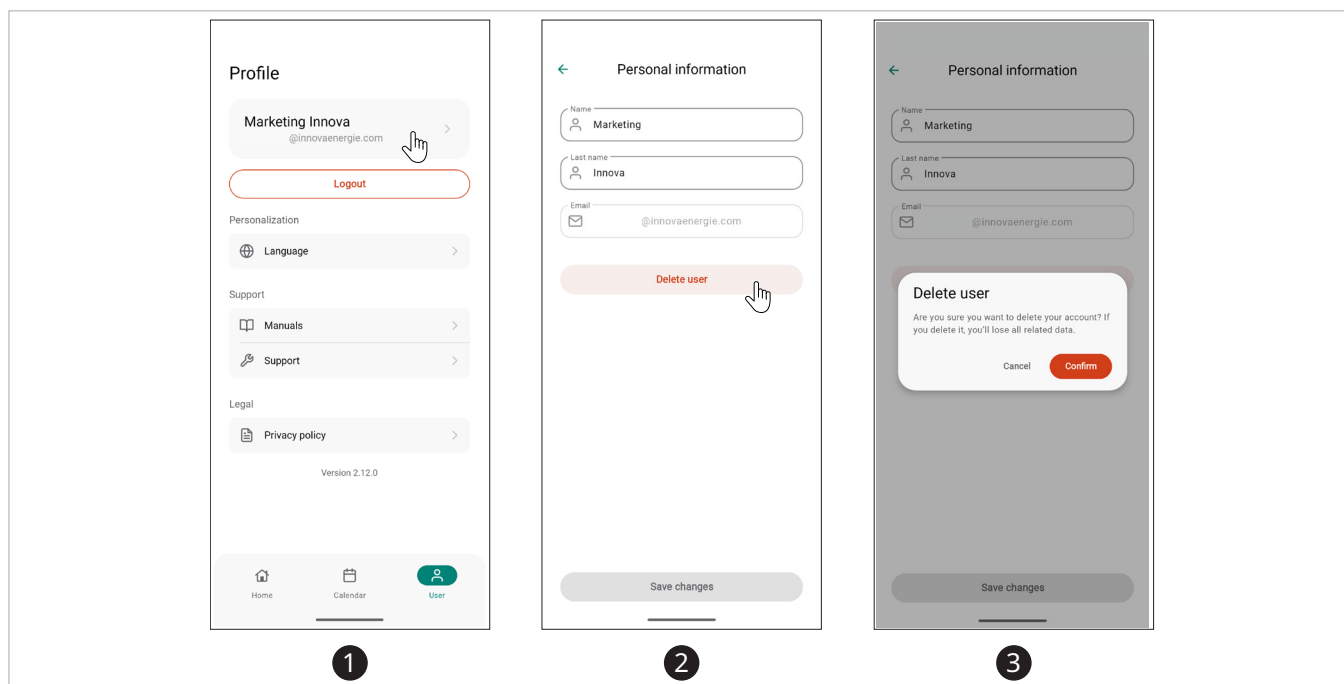

To check the user's personal information

- ▶ select user
A screen appears with the user's personal information.
You can edit the user's first and last name or delete the user.

To edit the user's personal information

- ▶ select the space you want to modify
- ▶ edit
- ▶ select save changes
The information is changed.

To delete the user

- ▶ select delete user
A warning appears asking if you want to delete the user.
- ▶ select confirmation
The user is deleted.

4.3 Request for assistance

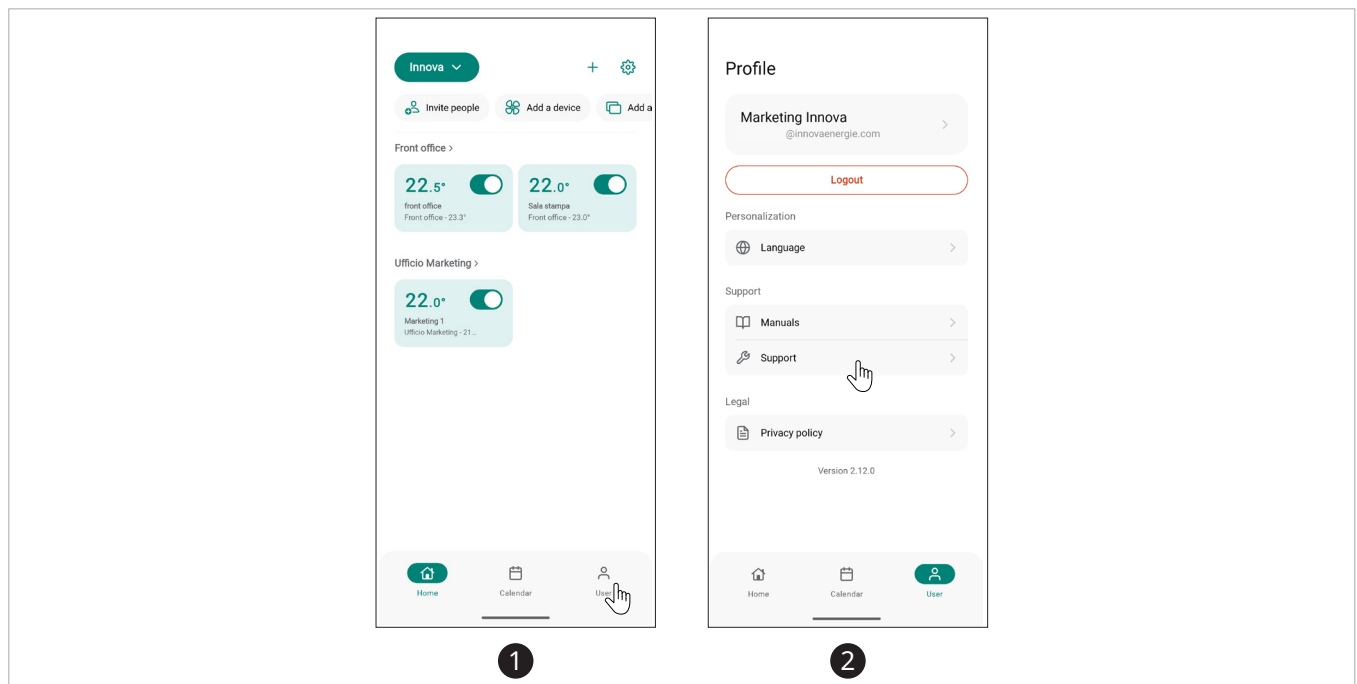

To request assistance

- ▶ select user
A screen with general settings appears

- ▶ select support
The email opens where you can request assistance.

4.4 Calendaring

The application includes a calendar system that allows you to schedule the week for all devices configured within the home.

A calendar can be associated with a device.

Calendar associated with the device: applied to the individual device

4.4.1 Creating a calendar

Calendar is one of the key features of the application; it is possible to create more than one according to periods (e.g. summer, winter).

⚠ You can create multiple calendars, but it is only possible to activate one calendar at a time.

Inside the calendar there are presets, which can be customised directly by the user.

The preset is the set of configurations of one or more devices desired by the user.

⚠ It is not mandatory to configure the devices.

Preset:

- Night
- Comfort
- Eco
- Outside
- Antifreeze
- etc.

⚠ A different preset can be set for each device.

⚠ The preset is associated by the user with a time slot.

⚠ It is necessary that all 24 hours of a day are associated with a preset.

⚠ When creating a new calendar, the comfort preset is used by default.

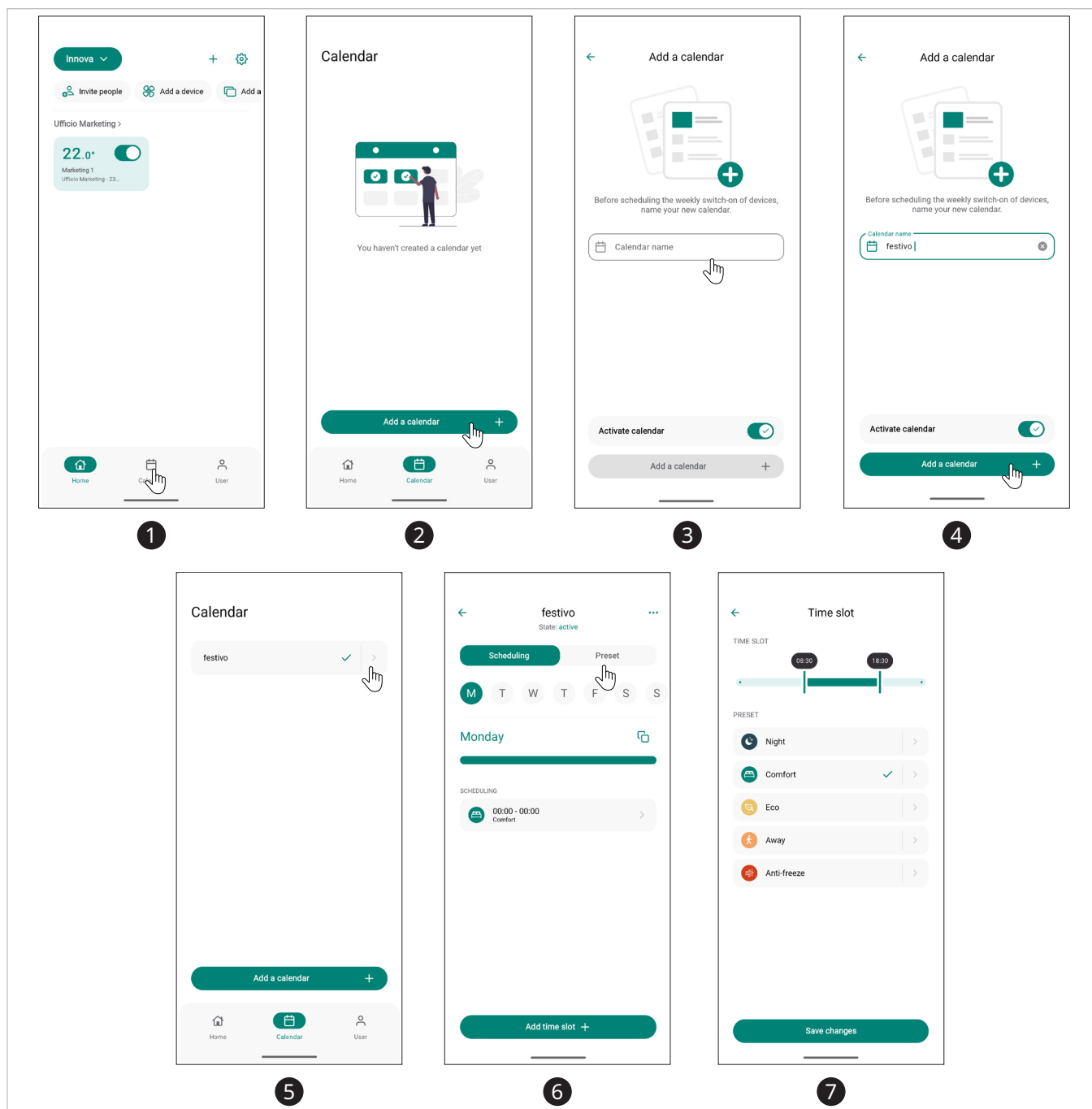

To create a calendar

- ▶ from the main screen, select the calendar icon
A screen appears where you can add one or more calendars.
- ▶ select add calendar
This takes you to the name entry screen.
- ▶ enter the name you want to give to the calendar
- ▶ select add calendar
The calendar appears.

⚠ A green check mark indicates that the calendar is active.

To customise a calendar

- ▶ press on the grey indicator to access the calendar
The comfort preset appears in the calendar.
- ▶ select preset
A screen appears with all available presets.

⚠ In this screen you can configure one device at a time, setting the desired temperature in a specific preset.

⚠ It is possible to configure the same device in several presets.

⚠ Once the required devices have been configured, a schedule can be created.

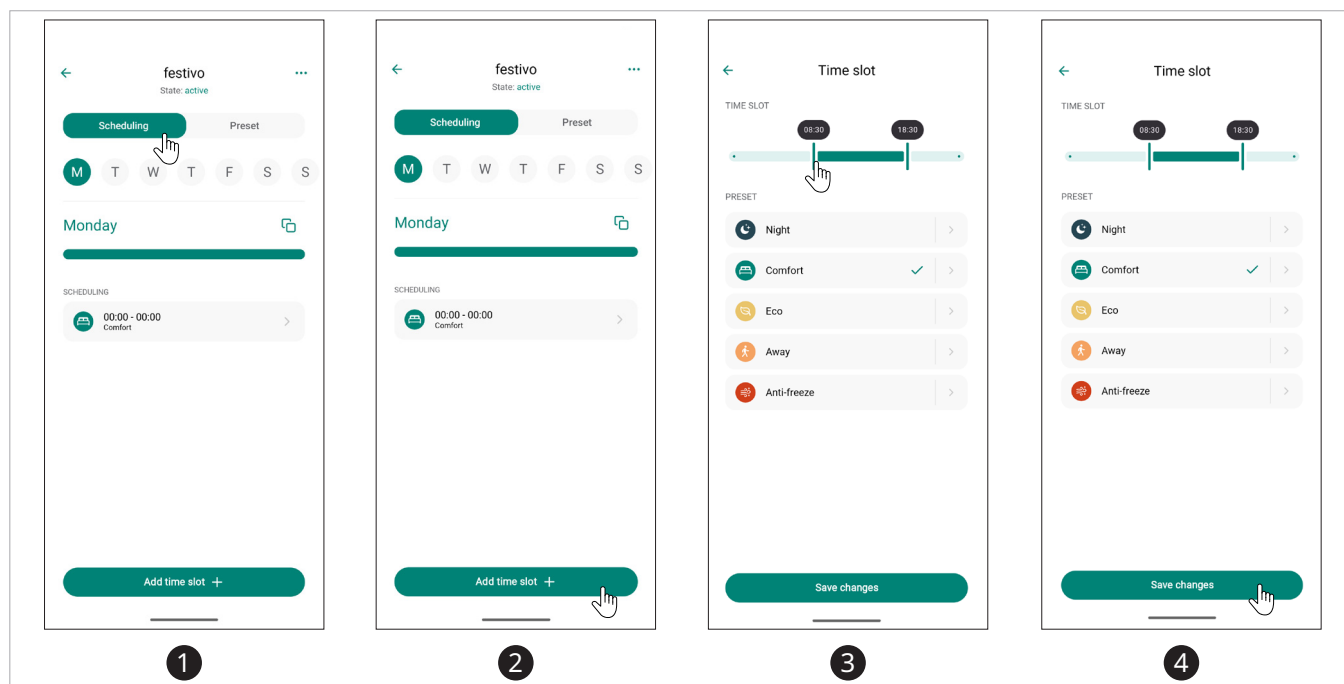
**To create a schedule**

- ▶ select scheduling
 - ▶ select add a time range
 - ▶ select one of the presets
 - ▶ edit the time slots according to your needs
 - ▶ select save changes
- The set schedule appears when you return to the schedule screen.*

⚠ The number of intervals you can enter is unlimited.

⚠ Automatically the comfort programming (entered by default) will be changed.

⚠ At the moment, programming is only active for one day.

To copy a day's schedule

- ▶ select the copy icon
 - ▶ select the days you want to copy the schedule
 - ▶ select confirmation
- The copied schedule message appears.*

⚠ The schedule has been copied to the selected days.

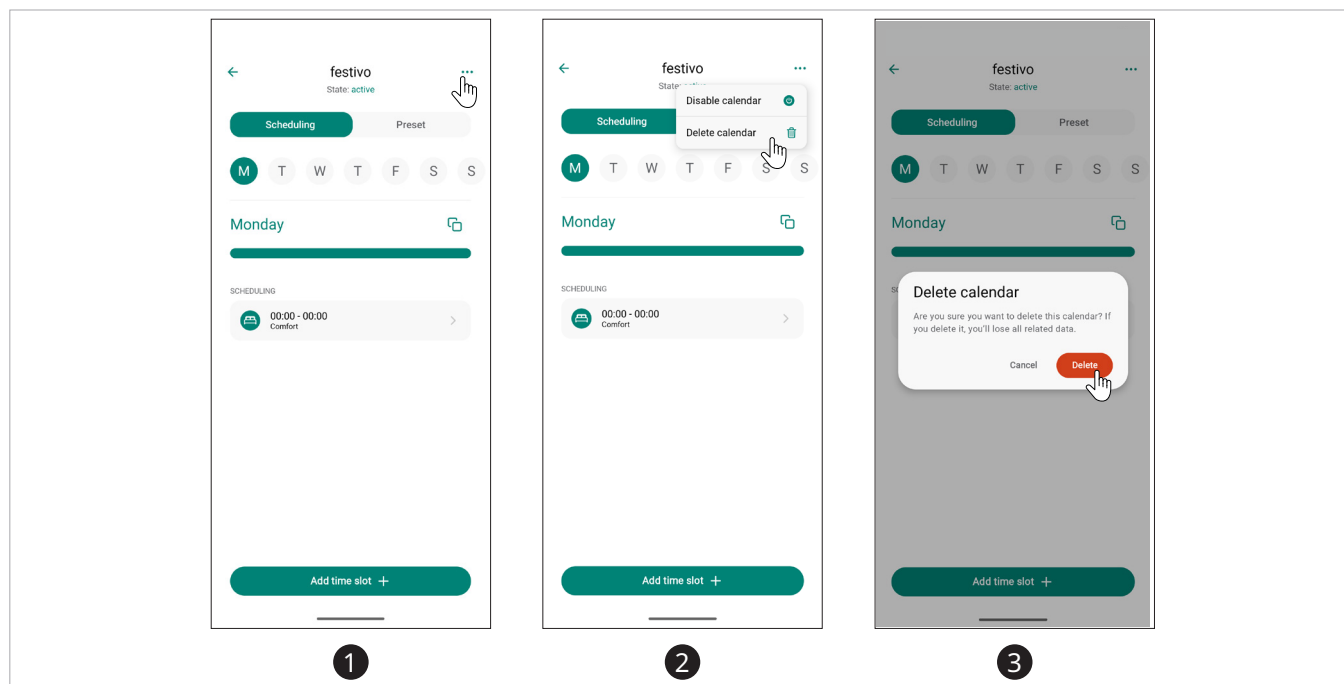
4.4.2 Deleting a calendar

To delete a calendar

- ▶ from the screen with the list of calendars
- ▶ select the 3 dots
A drop-down menu appears that says delete calendar.

- ▶ select delete calendar

A warning appears asking if you are sure you want to delete the calendar.

- ▶ select delete

You will return to the screen with the list of calendars.

The calendar is deleted from the list.

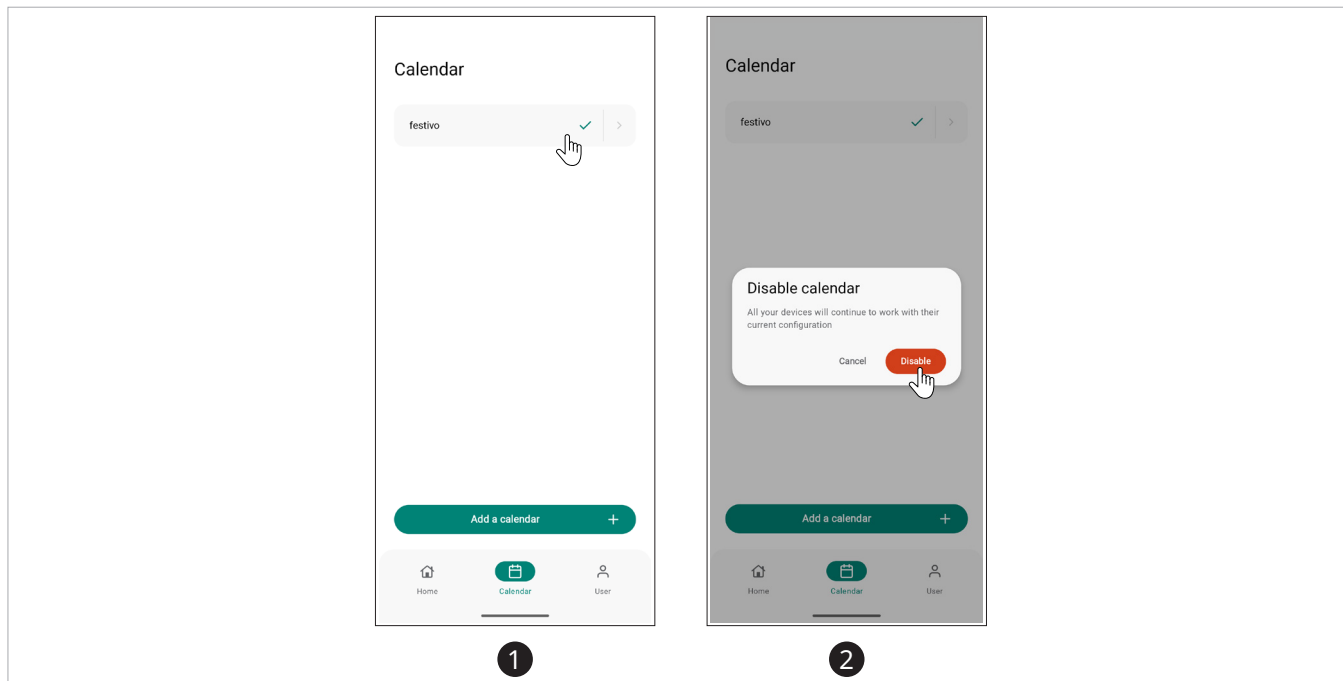
4.4.3 To disable a calendar**To disable a calendar**

- ▶ from the screen with the list of calendars
- ▶ select the calendar to be deactivated
A warning appears where you are asked if you are sure you want to disable the calendar.
- ▶ select disable calendar
The calendar is turned off.

⚠ To rehabilitate the calendar do the same operation again.

4.5 New device

This function allows other appliances to be configured after the first configuration.

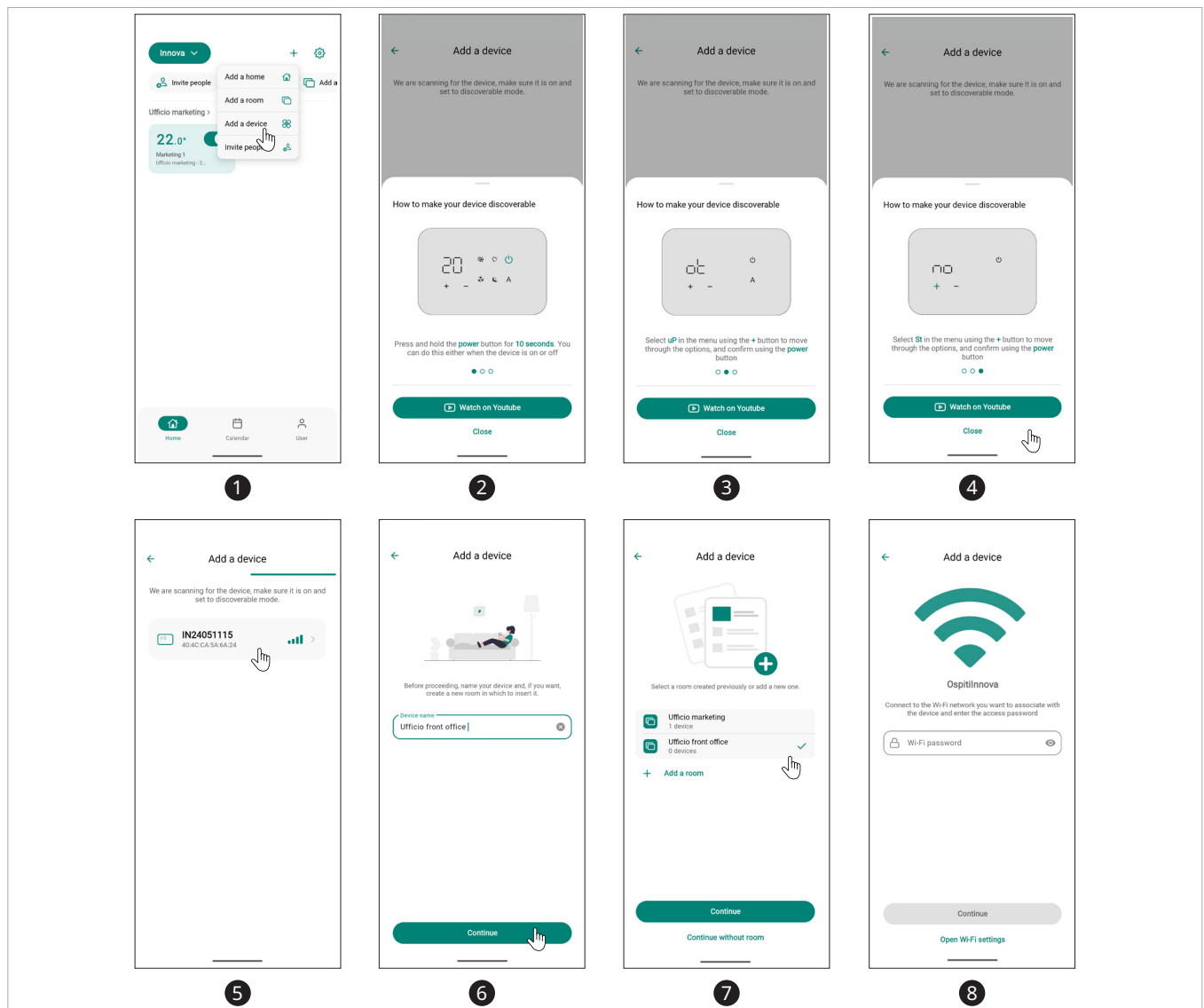

To configure a new device

- ▶ select +
- ▶ select add a device
- ▶ See the instructions for making your device detectable, or watch the video
- ▶ enter the name you want to give the device
- ▶ select continue
- ▶ add the device to a room or continue without a room
- ▶ select continue
- ▶ A screen appears where you need to select a Wi-Fi network.
- ▶ enter password
- ▶ select continue
- ▶ The device is successfully added.

⚠ The device remains visible only for the first 15 minutes after being turned on, after which it is necessary to manually activate the configuration procedure or remove and restore power to the device.

⚠ If you are not connected to a network, you will be prompted to connect to a Wi-Fi network and enter the password to configure the device.

⚠ If the new device cannot be added, press retry and repeat the same operation.



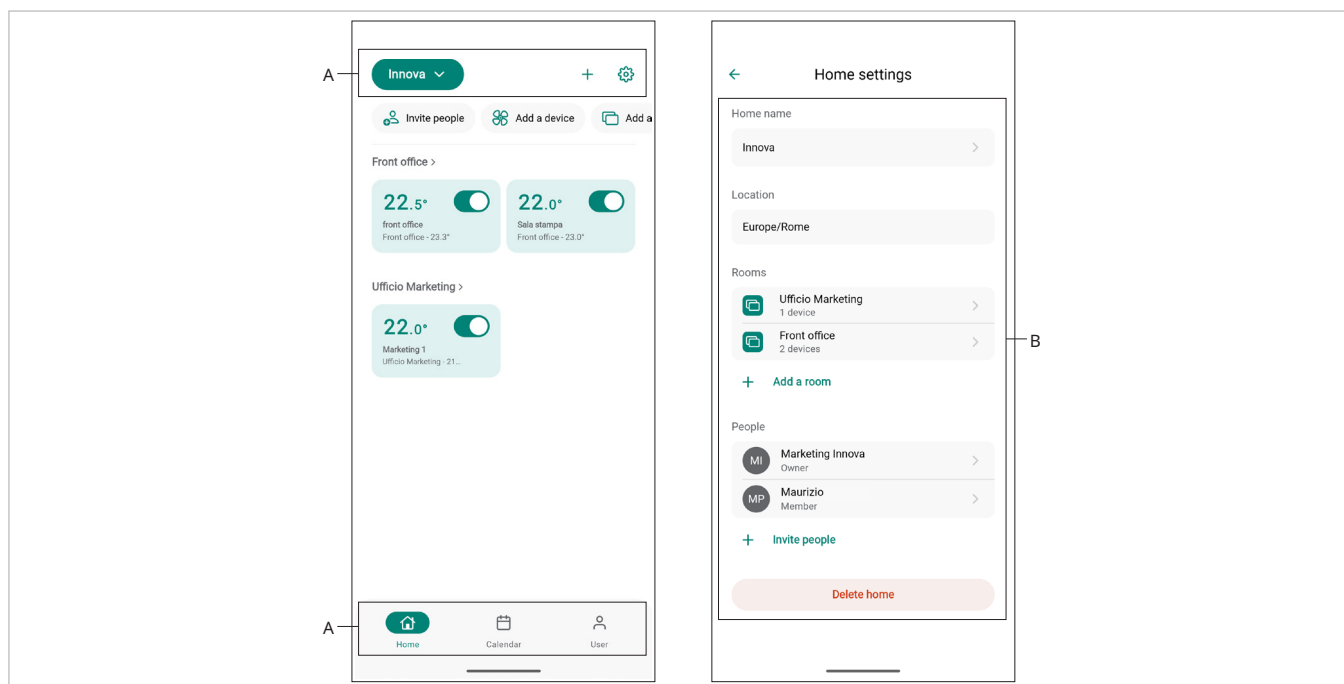

5. GENERAL SETTINGS

5.1 General settings

5.1.1 Interface



A: Navigation bar

- ▶  Settings
- ▶  Home
- ▶  Calendar
- ▶  User

B: General settings

- ▶ House name
- ▶ Positioning
- ▶ Rooms
- ▶ People
- ▶ Delete home

Rooms: allows you to edit room names, order rooms, delete a room, or add a room

People: allows you to edit a person's role or invite people

Delete house: allows you to delete the house

⚠ If you are the owner of the house and there are still devices in the house, you cannot delete the home. You must transfer your ownership to delete it.

5.1.2 Description

House name: allows you to edit the home name

5.2 Manage homes

A house can represent either an entire building or an apartment consisting of rooms.

You will not be able to create, modify, share, or delete one or more houses with this function.

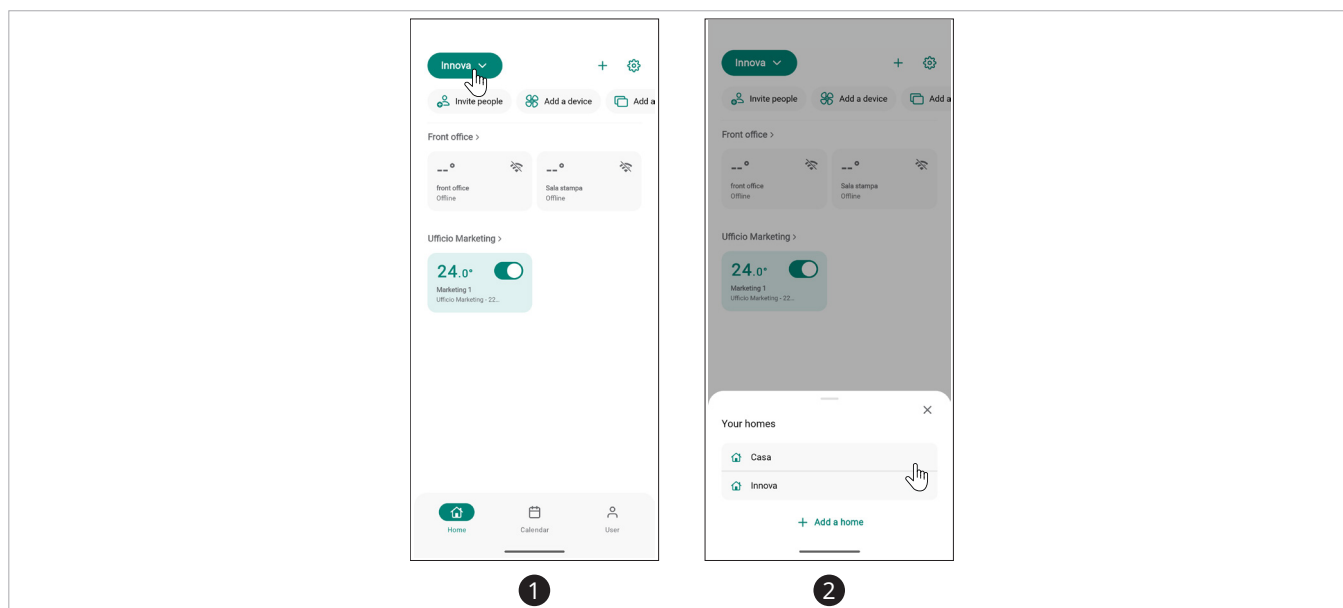

To select your home

- select the home name
A screen appears showing your houses.

To view a different house from those listed

- select the home you want to view
The main screen of the selected home appears.

⚠ In the list of houses, the selected home is displayed with a checkmark.

5.2.1 Add a home

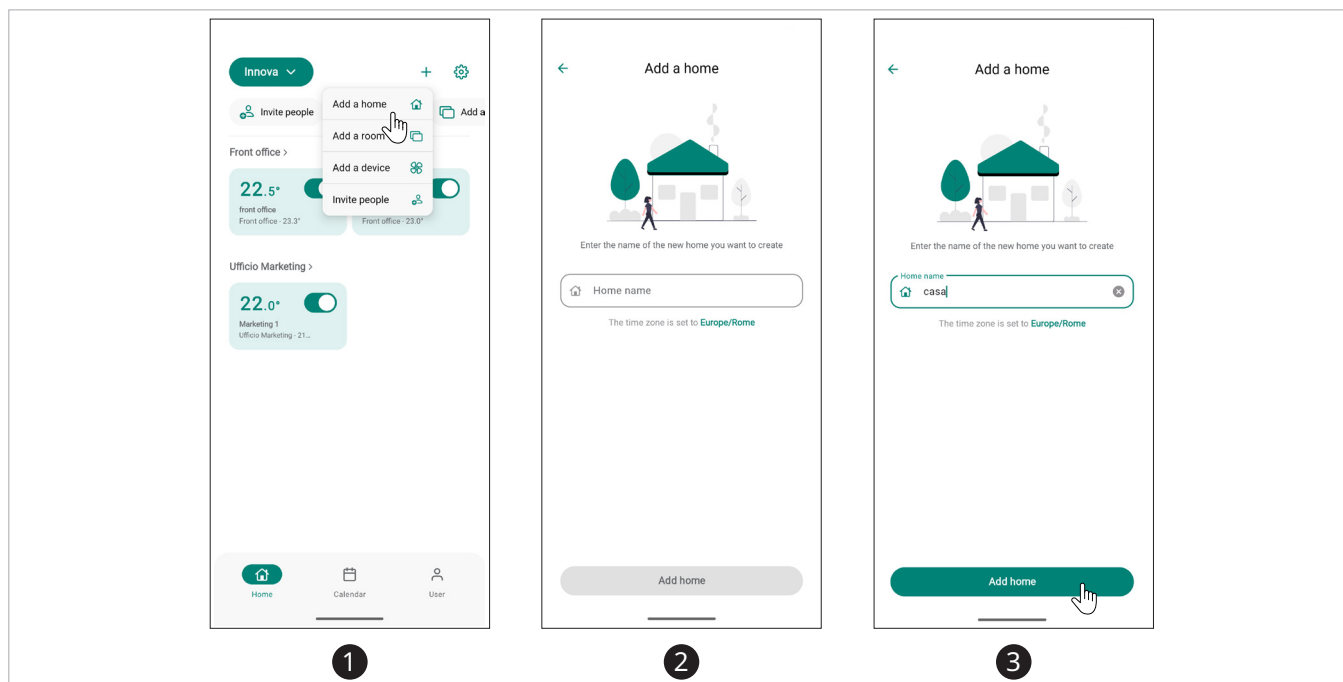

To add a home

- press +
- select add a home
This takes you to the name entry screen.
- enter the name you want to give the new home
- select add a home
Return to the homes list screen.
The newly created home appears in the list.

⚠ The new house is created empty, without rooms and devices. In order to use the functions, it is then necessary to configure the devices and create the rooms within it.

⚠ For configuring a new device, refer to the paragraph "New device" *p. 20*.

5.2.2 Change the name of a home

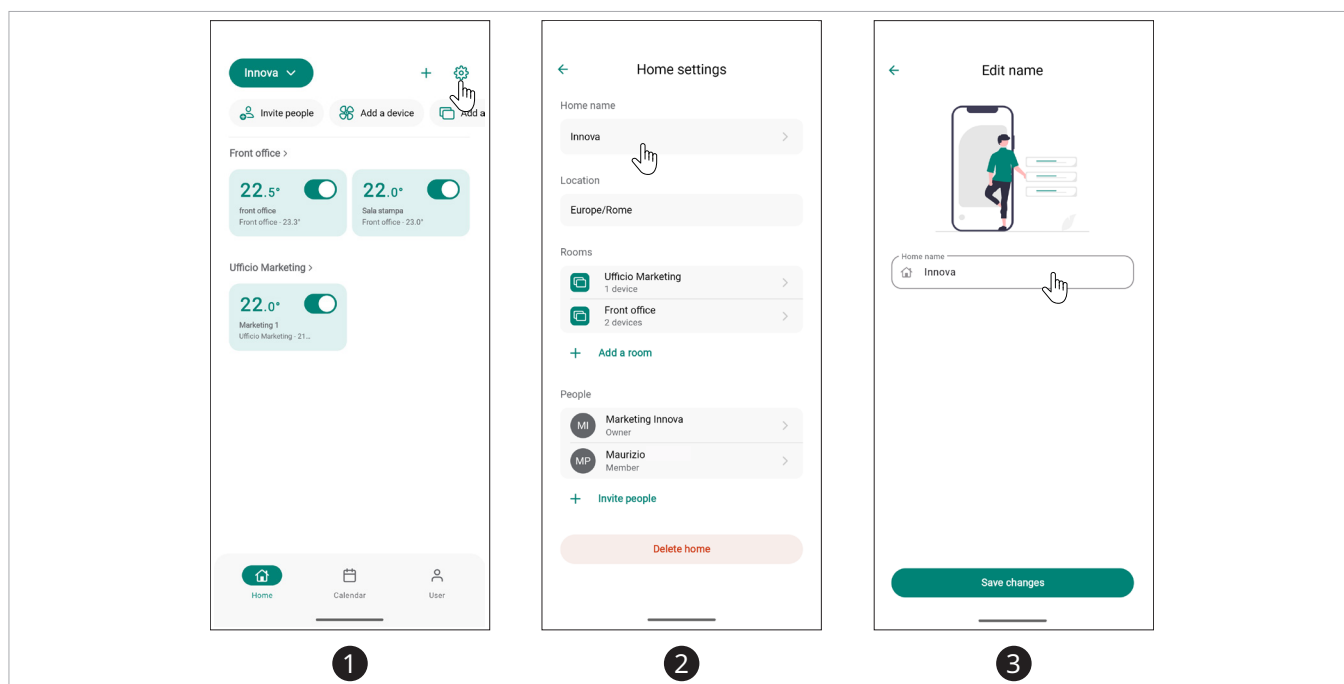

To change the home name

- ▶ select settings
 - ▶ select home name
- The screen for editing the name is accessed.*

- ▶ enter the name you want to give the home
 - ▶ select save changes
- Return to the homes list screen.
The home with the new name appears.*

5.2.3 Sharing a home

It is possible to share a home with other users or add new users.

Owner: can view, manage, and share the house with other users or delete a user or home and transfer ownership to another user

Member: can view, manage, and share the house with other users

Guest: can only view the operation of the house

- ⚠ To share a house, the user to whom the home is shared must have downloaded the App and registered.
- ⚠ It is not possible to share the home or add unregistered users to the App.
- ⚠ If you are the owner of the home, you can decide to transfer ownership to another user. See paragraph "Transfer ownership to another user" **p. 25**.

Add user

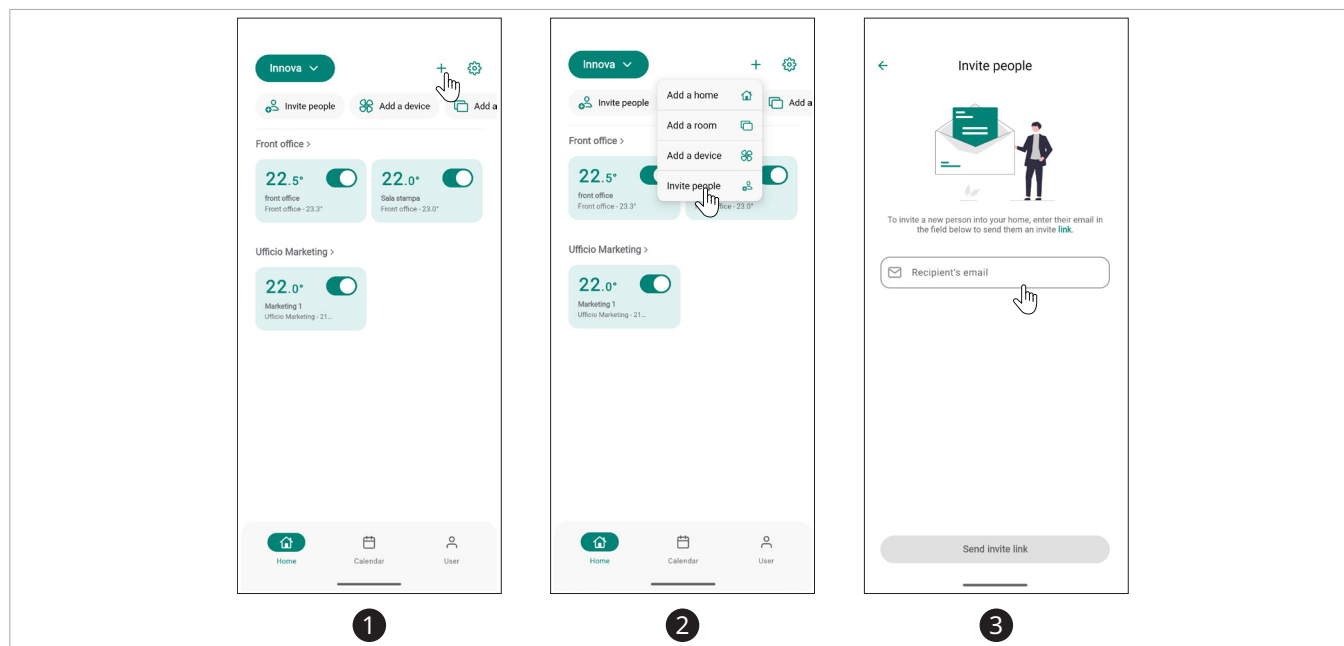

To invite someone to manage your home

- ▶ select +
 - ▶ select invite people
- The screen for inviting people is accessed.*

- ▶ enter the e-mail address of the person you wish to invite
- A link is sent by e-mail to the invited person.*

- ⚠ The invitation remains pending until it is accepted.
- ⚠ It is possible to revoke the invitation until it is accepted.

Change the role of a user

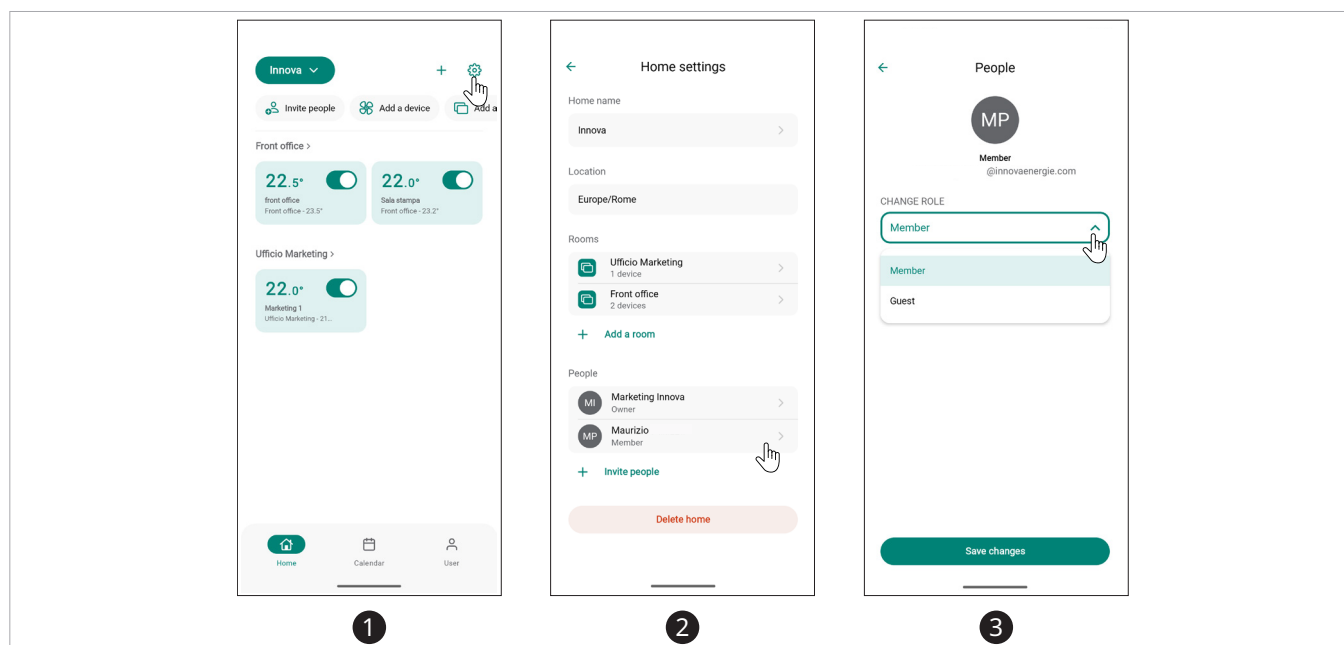

To change the user role

- ▶ select settings
 - ▶ select the user whose role you want to modify
 - ▶ select role
- The drop-down menu appears where you can change the user's role.*
- ▶ save
- You return to the home settings screen.*

- ⚠ To check the functions that a user can perform, refer to the paragraph "Sharing a home" p. 23.

Remove user

⚠ Everyone can eliminate their user from the home.

⚠ Only the owner can delete another user.

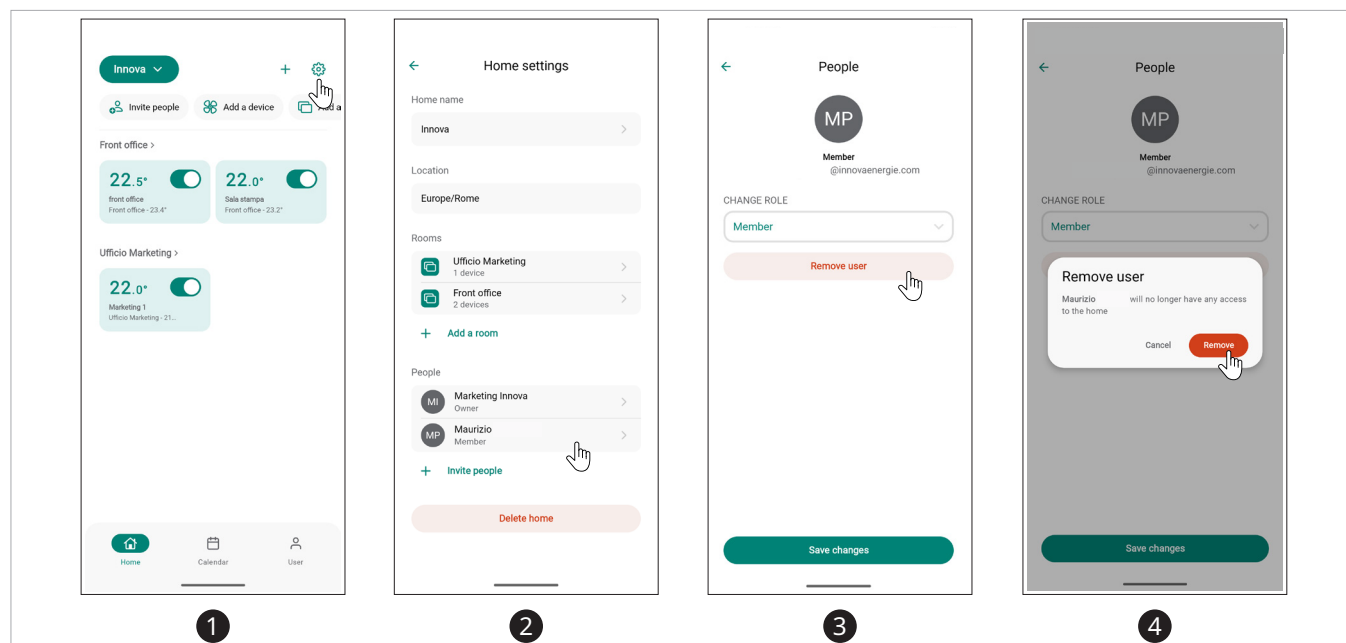

To remove a user

- ▶ select settings
- ▶ select the user you want to remove
- ▶ select remove user

A warning appears asking if you are sure you want to remove the user.

- ▶ select remove

You return to the home settings screen.

Transfer ownership to another user

⚠ Only the owner of the home can transfer ownership to another user.

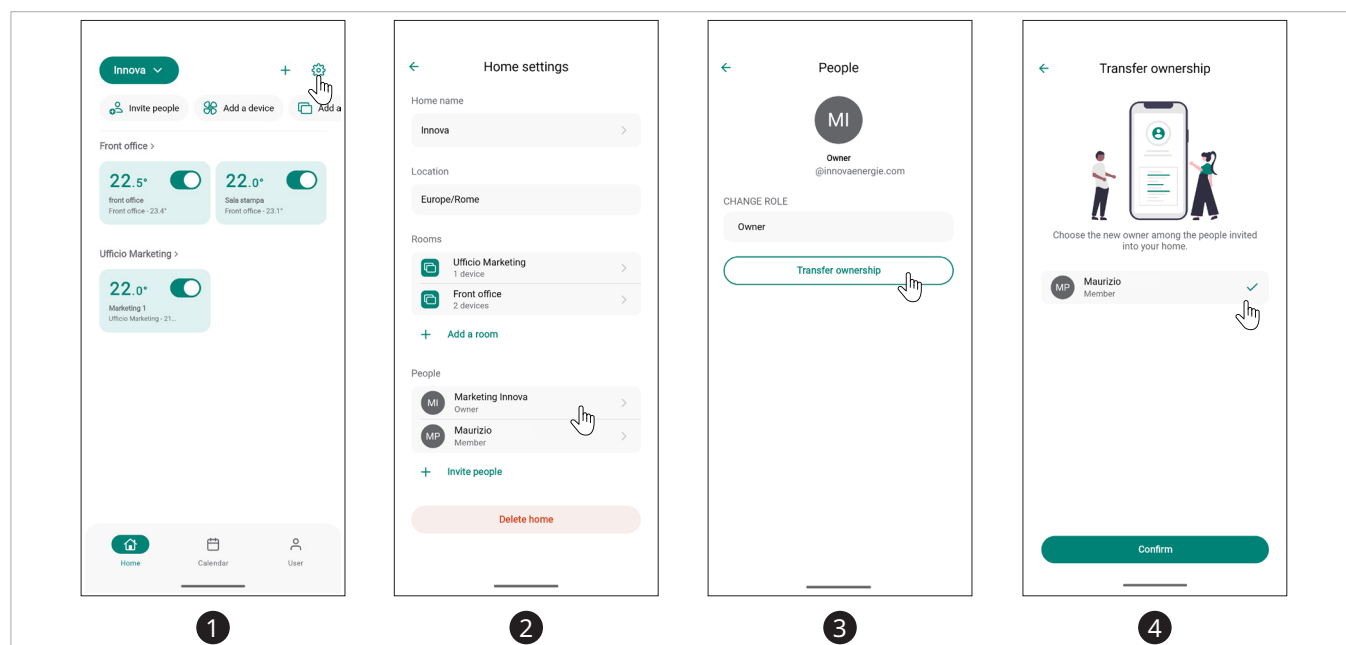

To transfer home ownership to another user

- ▶ select settings
- ▶ select the owner

The screen appears to transfer ownership.

- ▶ select transfer ownership
A screen appears where people are shown.
- ▶ select the person to whom you want to transfer the property
- ▶ select confirmation
The property is transferred.

5.2.4 Delete the home

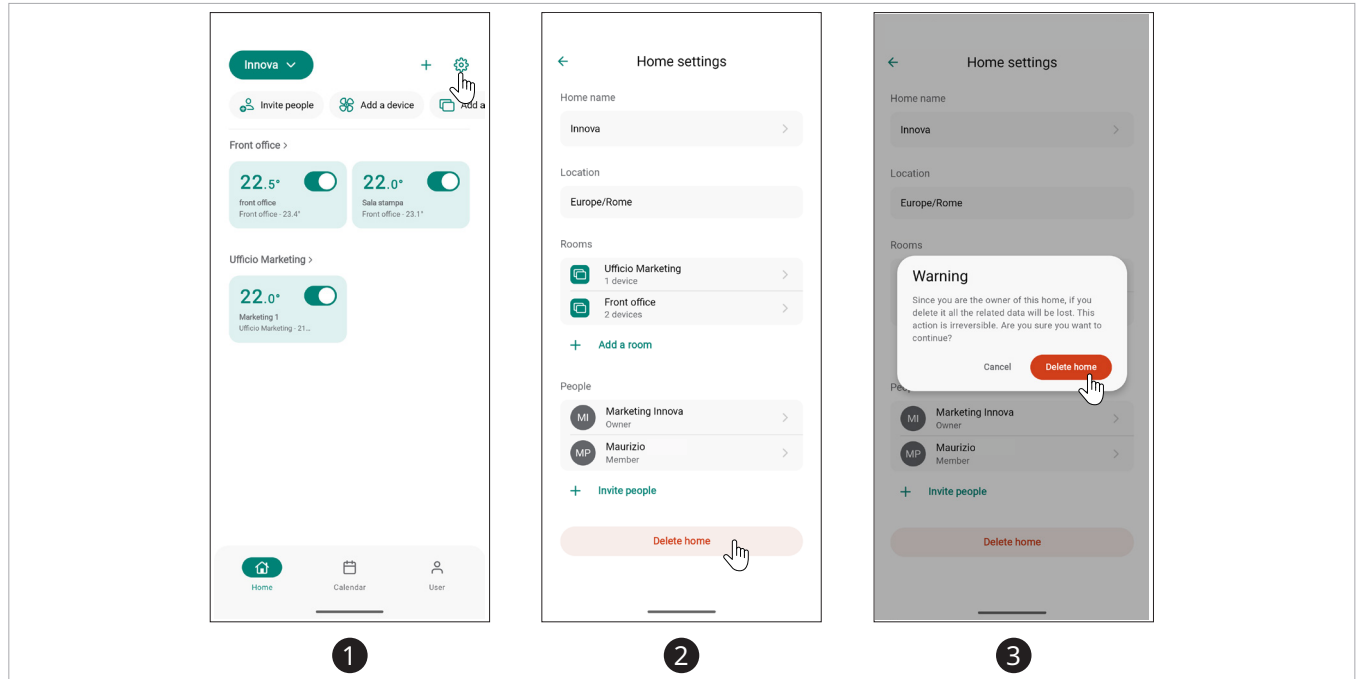

To delete a home

- ▶ select settings
- ▶ select delete home
A warning appears asking if you want to delete the house.

- ▶ select delete home
The home is deleted from the list.

⚠ If you are the owner of the house and there are still devices in the house, you cannot delete the home. You must transfer your ownership to delete it.

5.3 Manage rooms

In this section, you can recreate the rooms of the house and place the devices present.

Within this section, you can view the list of all rooms present in the current house, create, modify, or delete rooms.

By "room" is intended a container that can be:

- an entire floor of the house
- a room or space
- a specific environment

E.g. Room = ground floor where the appliances named "Kitchen", "Bathroom" and "Living room" are configured inside...

Room = Locale "Sala" where devices named Fan Coil 1, 2, 3... are configured

⚠ Home management is free and can be set by the user as desired.

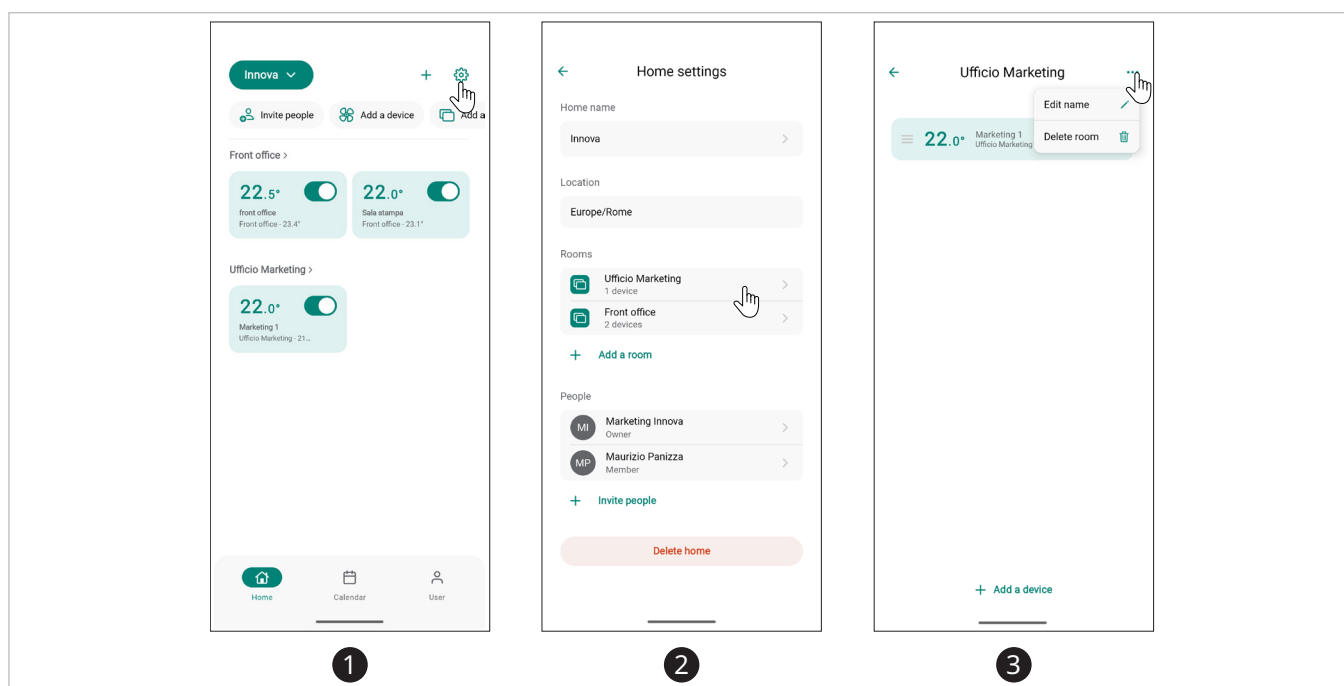

To manage a room

- ▶ select settings
- ▶ select the room you want to manage
You access the screen where the devices inserted in that room are visible.

⚠ From this screen, you can edit the room name, delete the room or order it, reorder devices, or add a device.

5.3.1 Add a new room

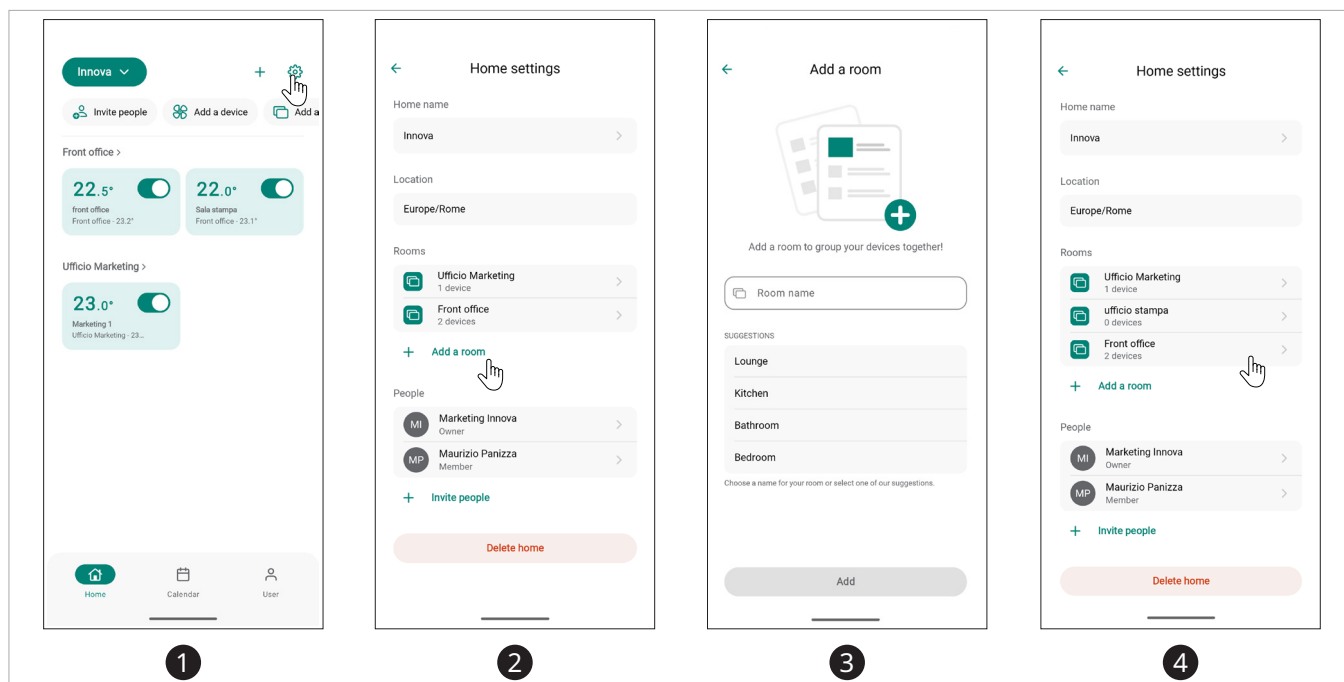

To add a new room

- ▶ select settings
- ▶ select add room
This takes you to the name entry screen.
- ▶ enter the name of the new room
- ▶ select add
*You will return to the screen with the list of rooms.
The newly created room appears in the list.*



5.3.2 Associating an appliance with a room

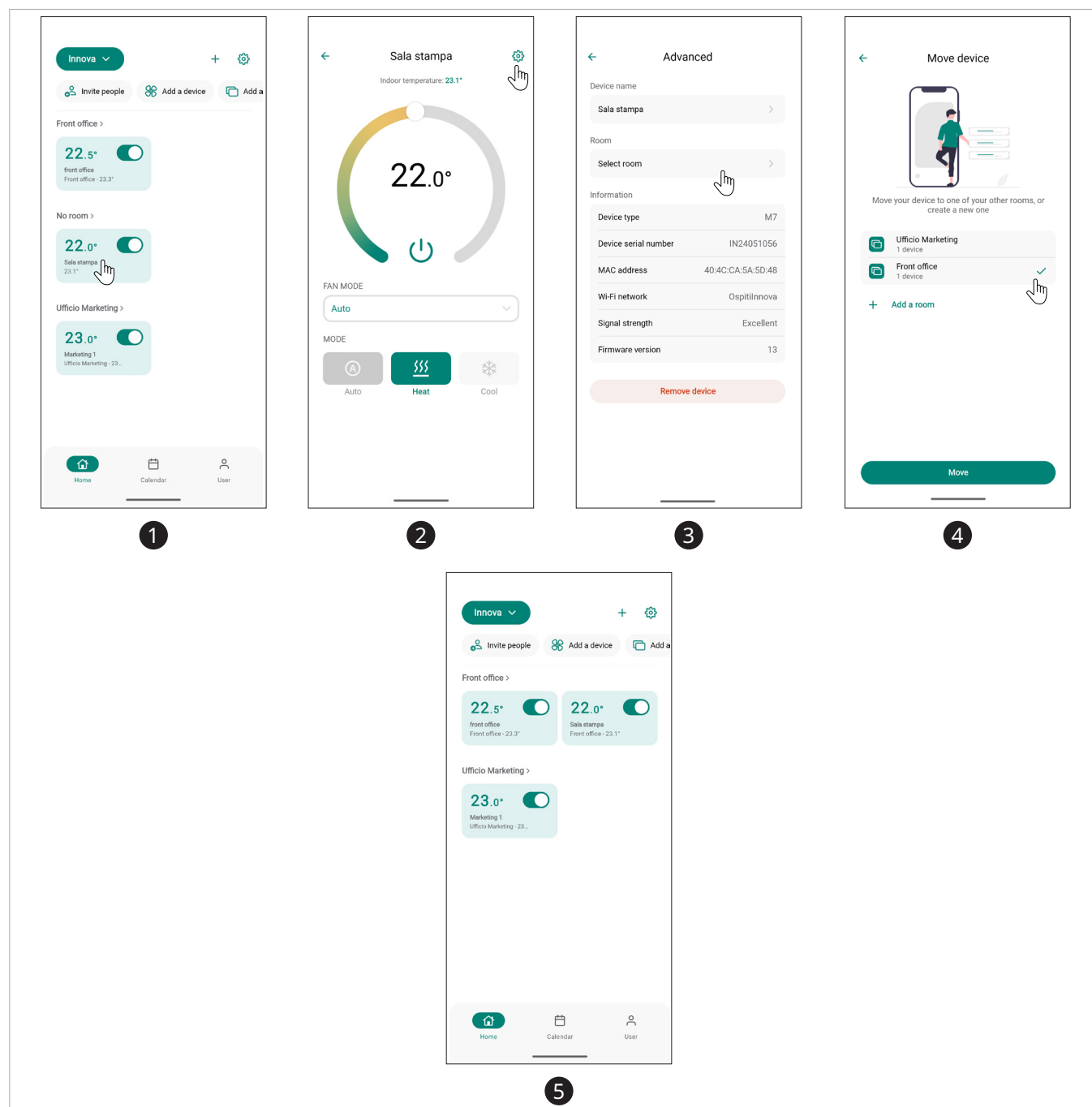

To associate a device with a room

- ▶ select the device to which you want to assign a room
- ▶ select settings
- ▶ select room
A screen appears with all existing rooms within the home, or it is possible to add a room.
- ▶ select the desired room or create a new room
- ▶ select move
You return to the initial screen where the devices are displayed.
The device appears in the new room.

5.3.3 Change the name of a room

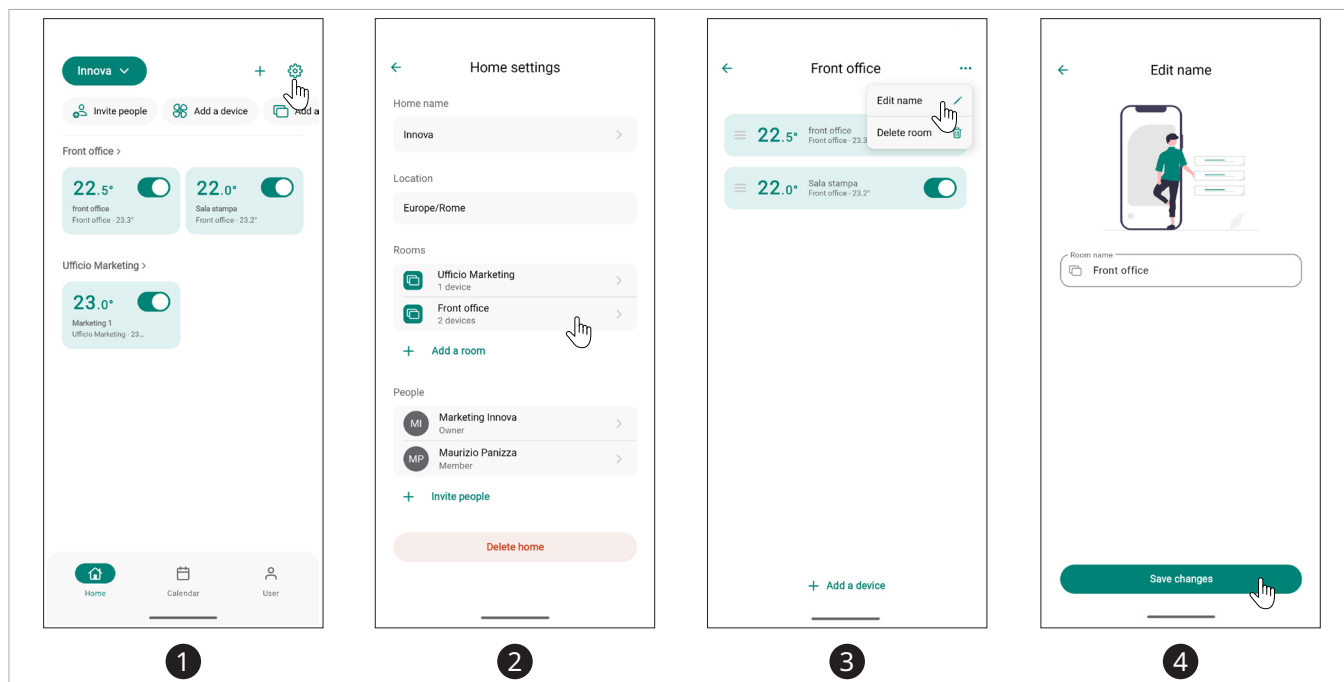

To edit a room name

- ▶ select settings
 - ▶ select the desired room
- The room management screen is accessed.*

- ▶ select change name
 - ▶ enter the new room name
 - ▶ select save changes
- You will return to the screen with the list of rooms.
The room with the new name appears.*

5.3.4 Deleting a room

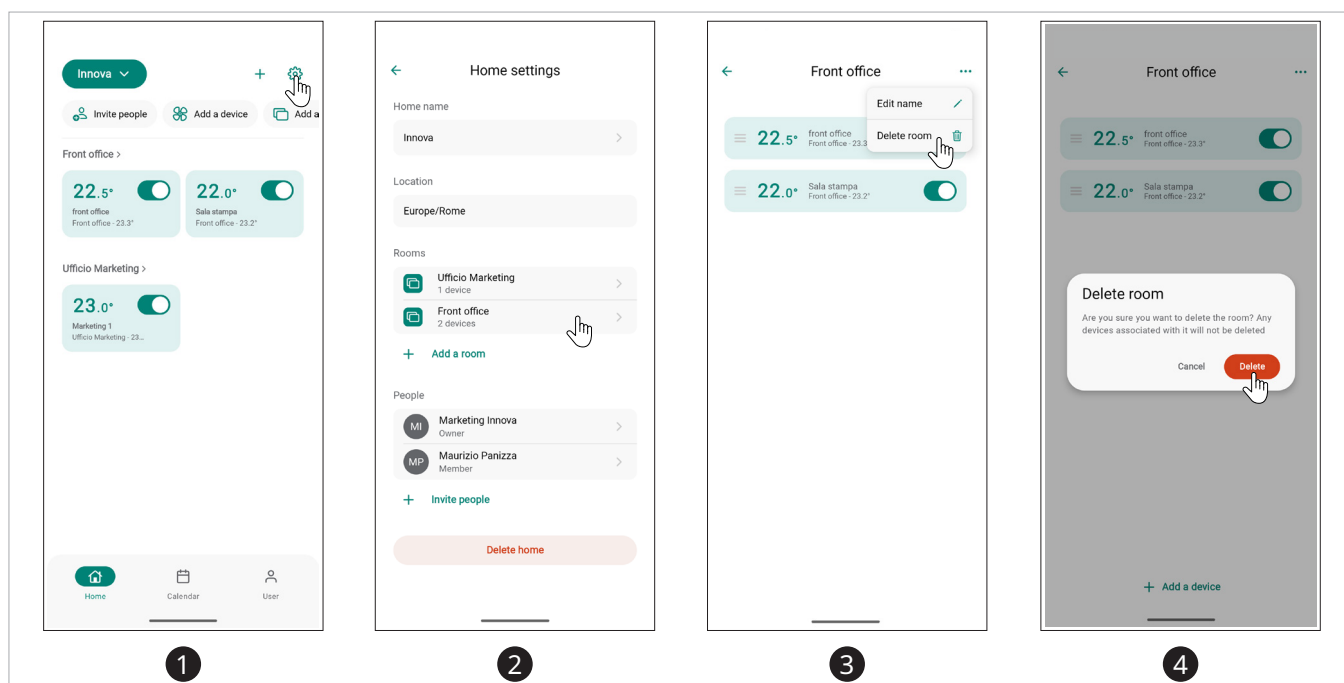

To eliminate the room

- ▶ select settings
 - ▶ select the desired room
 - ▶ select delete room
- A warning appears asking if you want to delete the room.*

- ▶ select delete
- The room is deleted.*

⚠ Devices in the room are automatically moved and placed in no room.

⚠ You can assign devices to a new room.

6. DEVICE SPECIFIC COMMANDS

6.1 Device specific commands

There are specific commands for each configured device.

⚠ Specific commands differ depending on the device selected.

To access

- ▶ from the main screen, select one of the devices present

This takes you to the device specific screen.

6.1.1 Interface

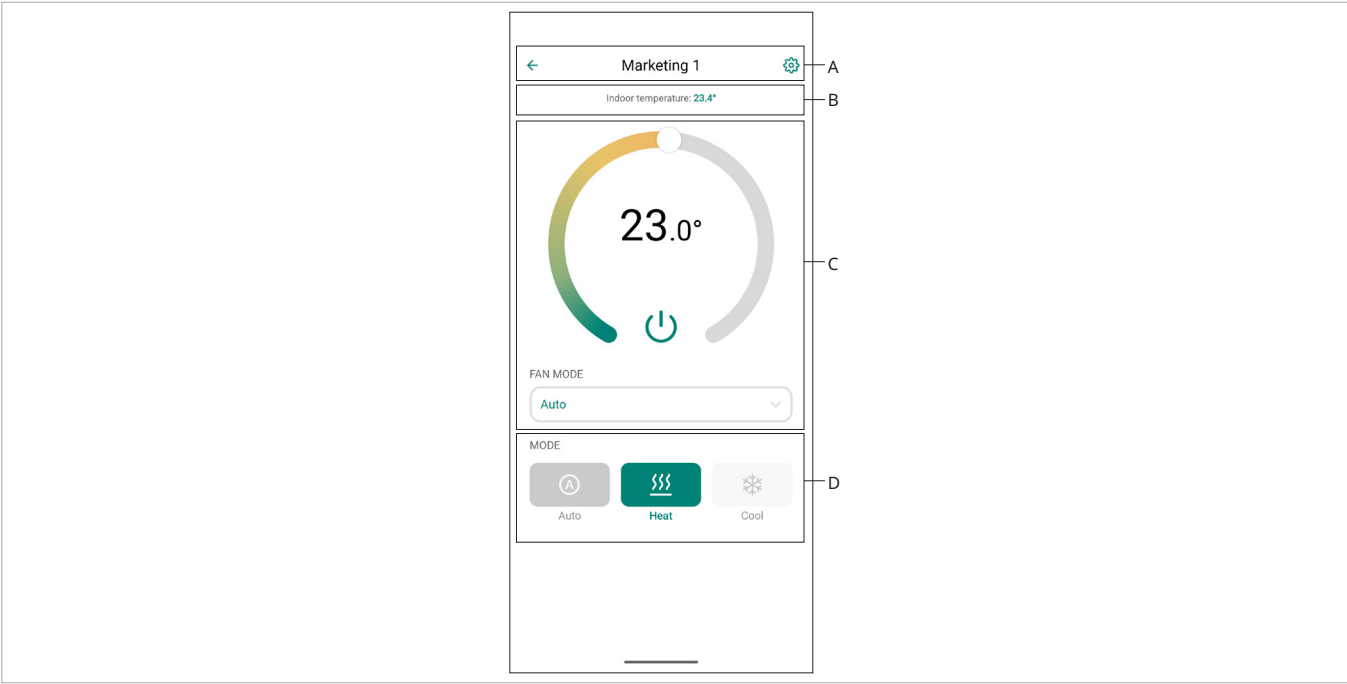

- A:** Navigation bar
- ▶ Go back
 - ▶ Device specific settings
- B:** Specific functions area
- ▶ The internal temperature and the room in which the device is placed are displayed.
- C:** Information area
- ▶ The set temperature, the fan operating mode, and the flap activation are displayed.
- D:** Device operating mode area
- ▶ Displays the device's operating mode.
- ⚠ The thermometer moves in increments of 0.5°C, and the user feels a clicking vibration with each movement.
- ⚠ Modes depend on device type.

6.1.2 Advanced settings for a single device

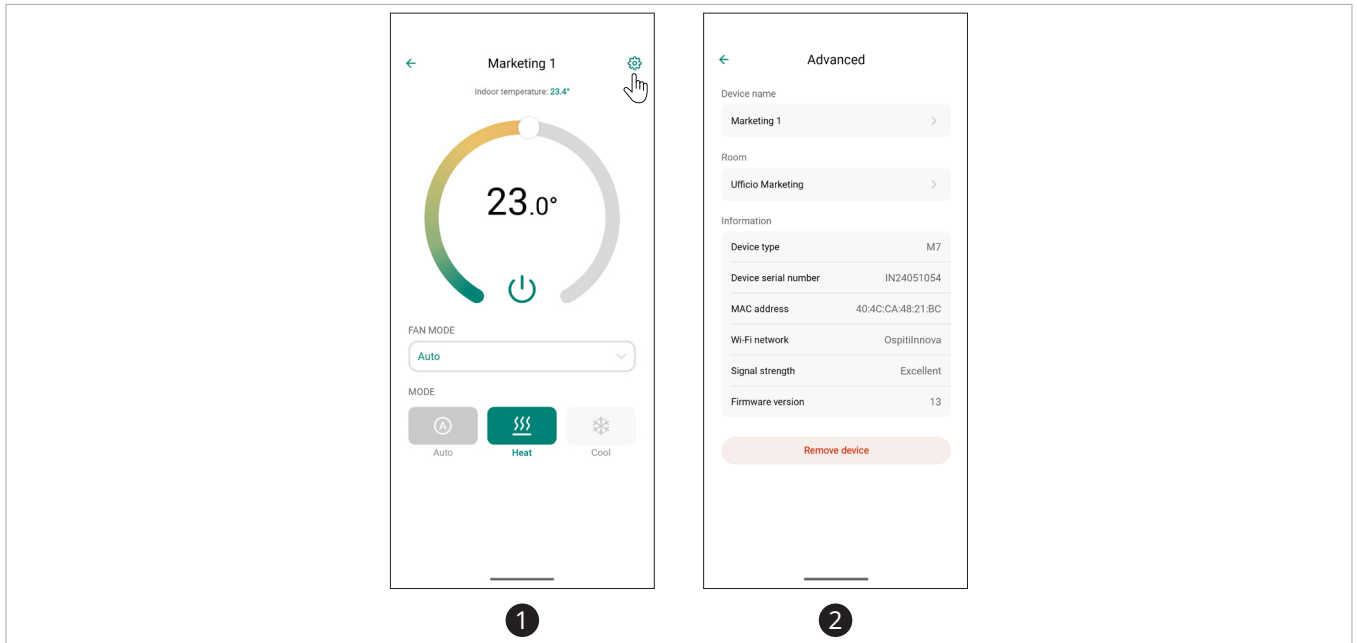

⚠ To access the advanced settings of the single device, you need to select a device.

To access advanced settings

- ▶ select a device
You access the device's main screen.
- ▶ select settings
You access the screen with advanced settings.

In the advanced settings, it is possible to:

- edit the device name
- move the device to another room
- check device information
- remove the device

Edit the device name

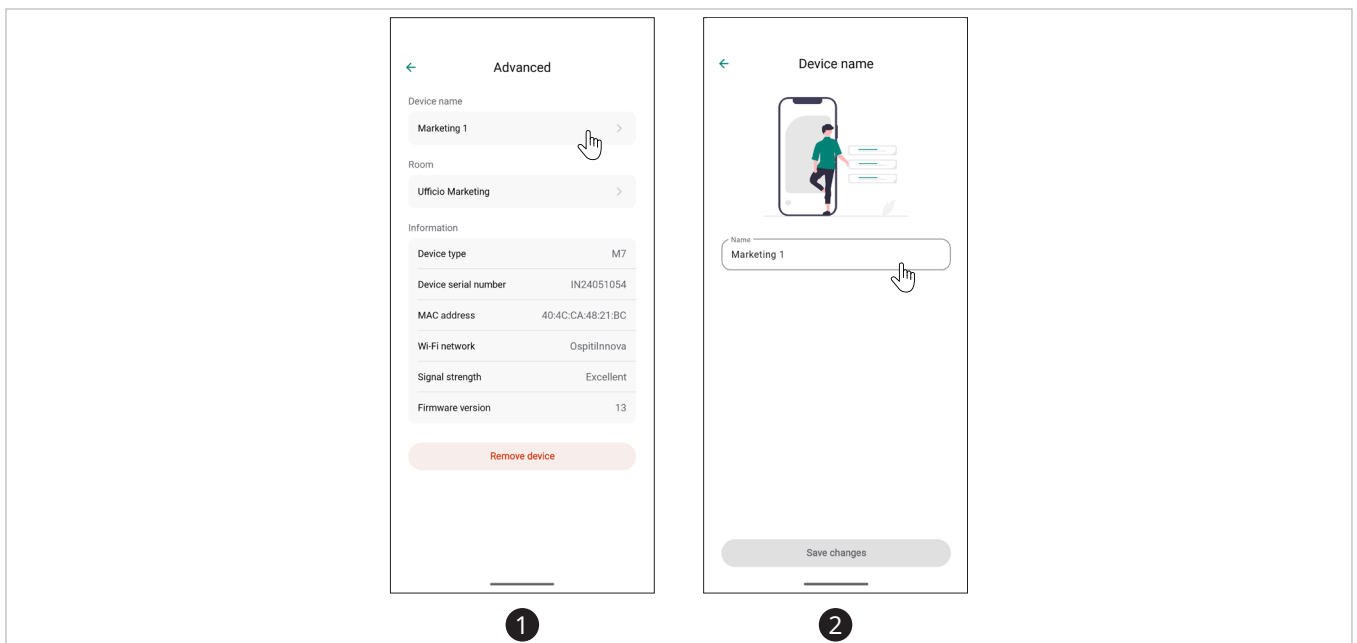

To change the device name

- ▶ access the screen with advanced device settings
- ▶ select device name
The user can access the screen to change the device name.

- ▶ edit the device name
- ▶ select save changes
*The name of the device is changed.
Return to the advanced device settings screen.*

Move the device

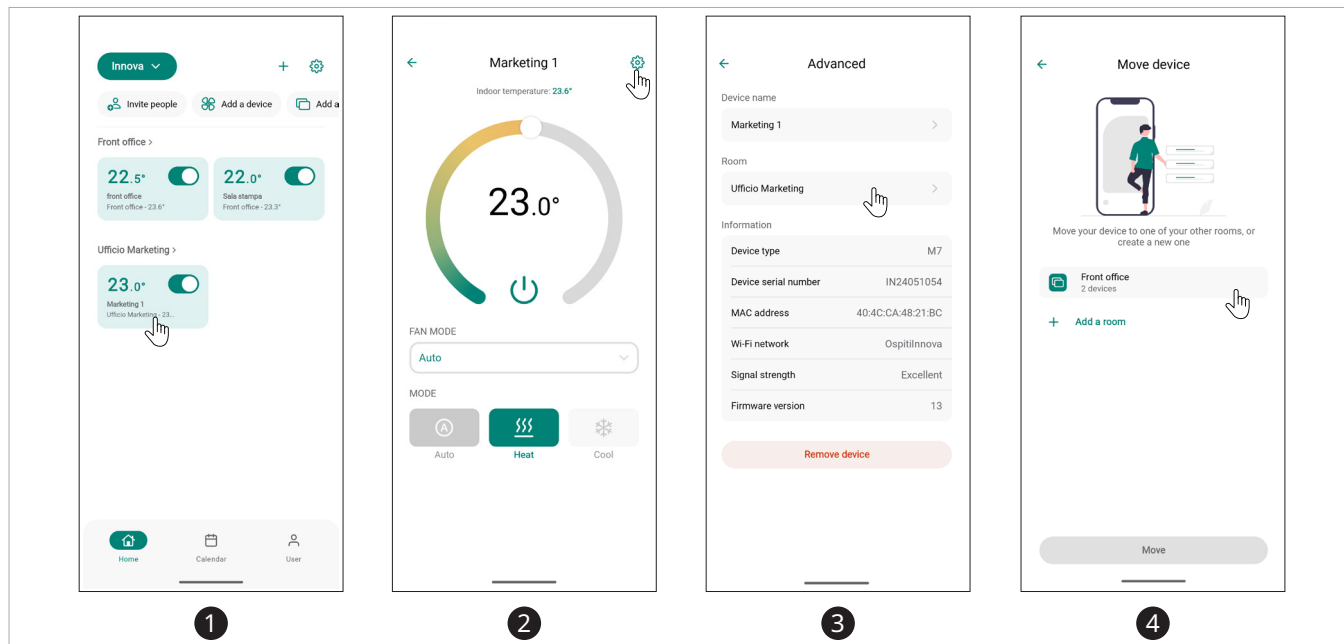

To move the device to another room

- ▶ access the screen with advanced device settings
- ▶ select the room you want to move the device to or create a new room
- ▶ select move

You access the screen with advanced device settings.

Remove the device

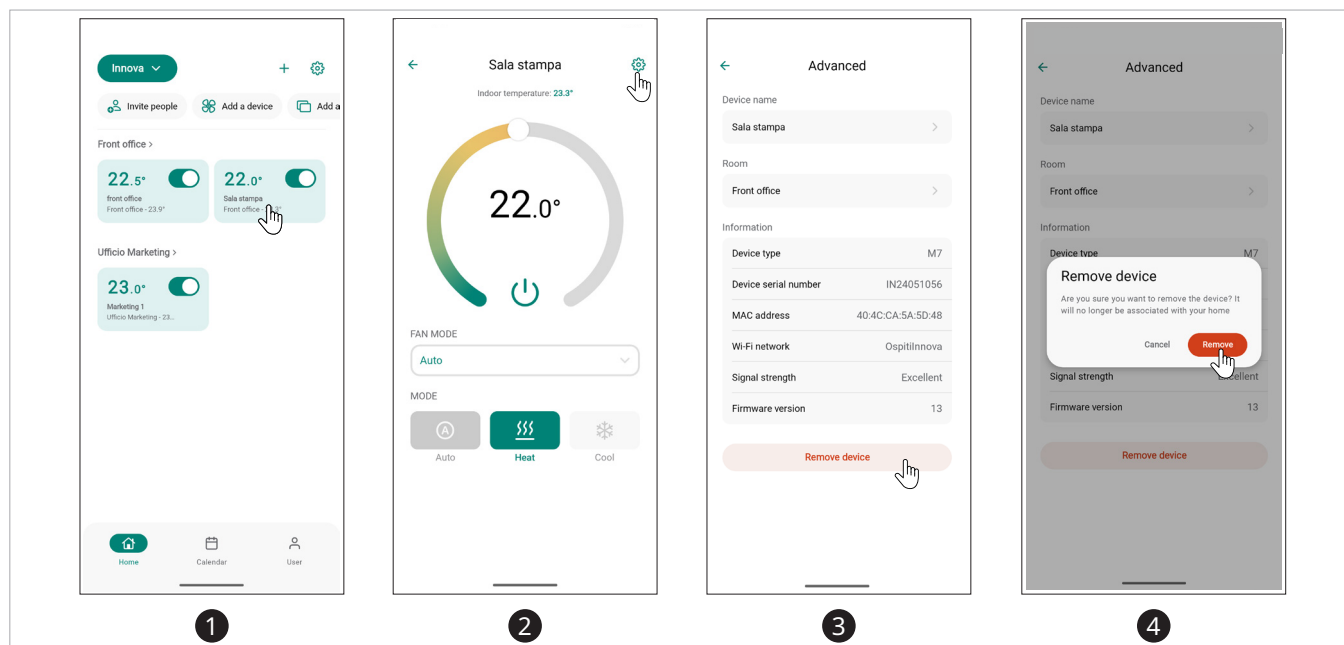

To remove the device





- ▶ access the screen with advanced device settings
- ▶ select remove

The device is eliminated.

7. ON, OFF, AND RESET OF THE WI-FI NETWORK

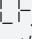
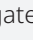
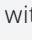

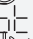

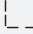
7.1 Onboard commands of an air conditioner

To activate the Wi-Fi network

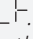
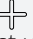
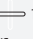

- ▶ press  for 10 seconds
Appears .
You are in the basic menu.
- ▶ use   to navigate within the menu
- ▶ select 
- ▶ press  to log in
- ▶ select  to enable Wi-Fi pairing
- ▶ press  to confirm
The change is confirmed by the appearance of the symbol .

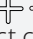
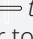
⚠ After a period of 30 seconds from the last action, the display exits the menu.

To reset the password and restore the device to the original configuration





- ▶ press  for 10 seconds
Appears .
You are in the basic menu.
- ▶ use   to navigate within the menu
- ▶ select ur
- ▶ press  to log in
no appear.
use   to navigate within the menu
- ▶ select cr to reset Wi-Fi connection credentials
- ▶ press  to confirm

To exit the basic menu

- ▶ press once 
Appears --.
- ▶ press  again
You exit the basic menu.

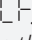
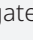
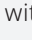

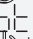

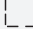
7.2 Onboard command EWA844 - EWA044

To activate the Wi-Fi network

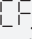
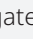
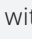

- ▶ press  for 10 seconds
Appears .
You are in the basic menu.
- ▶ use   to navigate within the menu
- ▶ select 
- ▶ press  to log in
- ▶ select  to enable Wi-Fi pairing
- ▶ press  to confirm
The change is confirmed by the appearance of the symbol .

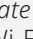
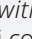
⚠ After a period of 30 seconds from the last action, the display exits the menu.

To reset the password and restore the device to the original configuration





- ▶ press  for 10 seconds
Appears .
You are in the basic menu.
- ▶ use   to navigate within the menu
- ▶ select uu
- ▶ press  to log in
no appear.
use   to navigate within the menu
- ▶ select cr to reset Wi-Fi connection credentials
- ▶ press  to confirm

To exit the basic menu

- ▶ press once 
Appears --.
- ▶ press  again
You exit the basic menu.

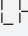
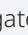
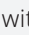

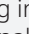
7.3 Onboard command EWF944

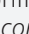
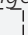
To activate the Wi-Fi network

- ▶ press  for 10 seconds
Appears .
You are in the basic menu.
- ▶ use   to navigate within the menu
- ▶ select 
- ▶ press  to log in
- ▶ select  to enable Wi-Fi pairing
- ▶ press  to confirm
The change is confirmed by the appearance of the symbol .

⚠ After a period of 30 seconds from the last action, the display exits the menu.

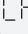
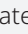
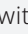
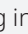
To reset the password and restore the device to the original configuration

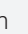

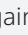

- ▶ press  for 10 seconds
Appears .
You are in the basic menu.
- ▶ use   to navigate within the menu
- ▶ select ur
- ▶ press  to log in
no appear.
use   to navigate within the menu
- ▶ select cr to reset Wi-Fi connection credentials
- ▶ press  to confirm

To exit the basic menu

- ▶ press once 
Appears --.
- ▶ press  again
You exit the basic menu.

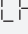
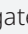

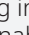

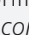
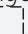
7.4 Wall control EFB749

To activate the Wi-Fi network

- ▶ press  for 10 seconds
Appears .
You are in the basic menu.
- ▶ use   to navigate within the menu
- ▶ select 
- ▶ press  to log in
- ▶ select  to enable Wi-Fi pairing
- ▶ press  to confirm
The change is confirmed by the appearance of the symbol .

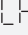
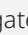
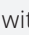
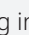
⚠ After a period of 30 seconds from the last action, the display exits the menu.

To reset the password and restore the device to the original configuration

- ▶ press  for 10 seconds
Appears .
You are in the basic menu.
- ▶ use   to navigate within the menu
- ▶ select uu
- ▶ press  to log in
no appear.
use   to navigate within the menu
- ▶ select cr to reset Wi-Fi connection credentials
- ▶ press  to confirm

To exit the basic menu

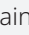
- ▶ press once 
Appears --.
- ▶ press  again
You exit the basic menu.

8. TROUBLESHOOTING

8.1 Error signals

⚠ In case of errors, please follow the instructions in the App carefully.

⚠ If the alarm symbol appears:

- ▶ select the symbol
- ▶ displaying the error message

8.2 Troubleshooting

Effect	Cause	Solution
Cannot find the device via the app	High distance from the device Useful configuration time (15 minutes) expired Device already configured Wrong app	Stay within 5 m range of the device Perform the device configuration procedure Device reset Download INNOVA App / INNOVA BUTLER
The device doesn't connect to the Wi-Fi network	The Wi-Fi network is not a 2.4 GHz network	Enabling a suitable Wi-Fi network
The application doesn't connect with the device	The app page has not been updated Device off Router replacement or Wi-Fi network password change	Update the app page (from within the app, by scrolling the page) Turn on the device Device reset
Unable to set a calendar and change the temperature	There is no suitable schedule available for the role	Ask a member or owner to change the role
Server Problem	The server is in maintenance	Wait



INNOVA S.r.l.
Via I Maggio 8 - 38089 Storo (TN) - ITALY
tel. +39.0465.670104 - fax +39.0465.674965
info@innovaenergie.com